

PLASTMAX

CN GB

- CN -	Betriebsanleitung	2
- GB -	Operating manual	28

警告!

砂浆喷涂机会产生喷涂高压。

	注意-小心受伤!
①	禁止将手或手指伸入喷射流内! 禁止将喷枪对着自己或他人! 涂料有腐蚀性和刺激性! 保护好皮肤和眼睛!
②	每次启动前, 必须遵守操作说明的要求, 并遵循以下几点: 1. 仅允许通过一个专用的馈电点和电源连接, 例如: 通过一个带故障电流保护装置 (INF \leq 30 mA) 的施工用配电器。建议使用电流为 30 mA 的 B 型 RCD (FI 开关)。 2. 注意最大操作压力。 3. 检查所有连接件是否有泄漏。
③	必须严格遵循本机定期清洁和维护说明的规定。 操作本机和每次作业暂停前, 必须遵循下列各点: 1. 注意涂料固化时间。 2. 对喷枪和砂浆软管进行泄压。 3. 将砂浆喷涂机关闭。

确保安全!

目录

1 安全规定	4
1.1 工作安全	4
1.2 运行安全	4
1.3 电气安全性	5
1.4 砂浆软管	5
2 前言	6
2.1 可处理的材料	6
2.2 技术数据	6
2.3 预混机的说明	7
2.4 说明示意图 (图 1)	7
2.5 设备上的操作元件和显示元件 (图 2)	8
2.6 砂浆软管 (图 3)	9
2.7 喷枪 (图 4)	9
3 运输	10
3.1 起重机运输	10
4 安装	11
4.1 电源连接	11
4.2 水源连接	11
4.3 连接砂浆软管	12
4.4 连接喷枪 (图 10)	12
5 投入使用	13
5.1 干粉材料	13
5.2 预先混合的材料	14
6 使用	15
6.1 更换胶套	15
6.2 工作间歇	15
7 机器的清洁和关闭	16
8 维护	17
9 维修	17
10 故障排除	18
10.1 显示屏中的错误信息	18
10.2 其它可能发生的错误	20
11 附件	22
12 备件清单	24
设备试验	26
产品责任方面的重要信息	26
处置说明	26
质保声明	26
服务网络	56

使用的符号解释

	本符号表示可能对您和设备构成危险。 在本符号处有如何避免对设备造成损伤和损坏的重要信息。
	表示提示信息和其他非常有用的信息。
	双手远离材料出口。
	不要移除防护格栅 活动部件存在挤伤危险
	噪音等级

1 安全规定

1.1 工作安全



本使用和维护手册必须由施工现场的负责人保管在施工现场，以供随时查阅。

本手册是机器的组成部分，在对机器进行废弃处理之前，必须妥善保管好本手册，以供将来需要时使用 (EN ISO 12100-2)。如果本手册遗失或损坏，则可从制造商处请求获取一份新的样本。

本手册包含 EC 一致性声明 (2006/42/EC) 以及有关施工现场准备和安装、使用、维护操作和备件订购的重要提示。但是，用户对机器的深入了解以及丰富的经验也是必不可少的：为此，必须由一名充分掌握本机器使用规定的人员对用户进行指导。

为了确保本机器的操作和运行安全性以及较长的使用寿命，请务必注意遵守本手册的说明以及有关工作场所安全和事故预防的相关法律标准（专用安全鞋、工作服、安全帽、手套、护目镜等的使用）。为了保护听力，请戴上耳塞。



Wagner 对因将本机器连接到其他制造商的机器和设备进行生产而造成的损失或损坏概不负责。

若未遵守有关如何使用本设备的法律规定（尤其是不当使用、不正确供给、缺少维护、未经允许对机器进行改装或改动、未遵守本手册的部分或全部说明），Wagner 则不承担任何责任。

Wagner 有权更改设备的特性以及本手册的内容，无需更新以前的机器和/或手册。

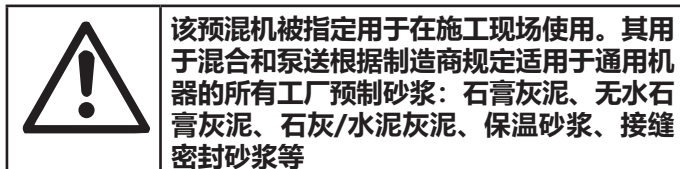

1.2 运行安全

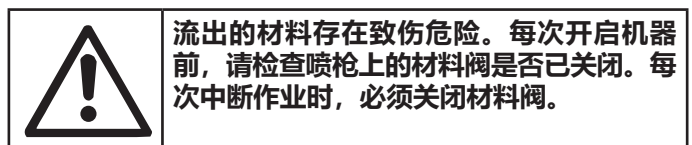
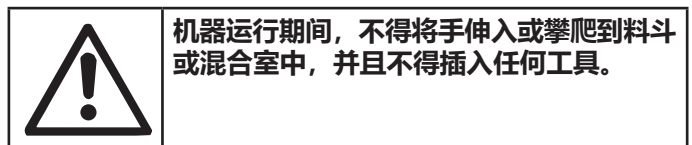
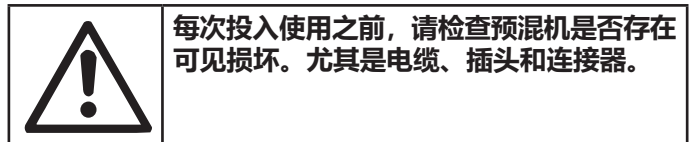
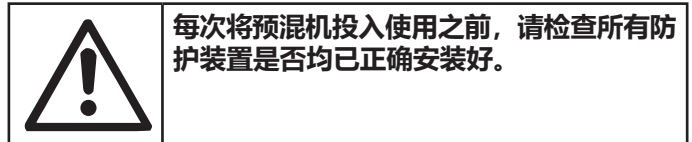

Wagner 预混机的所有危险位置均用合适的保护装置进行了保护，这些保护装置必须始终保持完好无损的状态并且已安装好。其中包括例如防止与混合器发生接触的电动机冷却风扇的外壳和料斗防护格栅。

尤其是凭借一个安全开关，可在电机法兰或料斗防护格栅打开时停止旋转的机器部件。

在工作区域内，必须遵守事故预防规定和安全说明。

操作料袋时，尽量不要造成材料扬尘，以免吸入。若无法避免，则必须使用防护面罩护住口鼻。

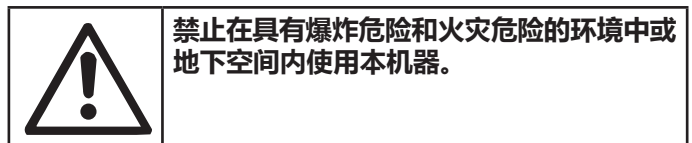

本混合器并未装配自带照明装置，因此，必须为工作区域提供充足照明。

进行清洁和维护作业之前，请关闭预混机。从插座中拔出电源插头。不得在压力作用下断开砂浆软管。断开之前，注意压力表上显示的压力。

在任何情况下不得使用猛烈的射束，尤其是不得使用高压清洁剂或蒸汽高压清洁剂冲洗设备。渗入的水会导致短路危险！

1.3 电气安全性

预混机 PlastMax 符合 EN 60204-1 标准的规定，并且具有防水喷射、过载和断电保护。

必须对预混机进行接地。

仅允许通过一个专用的馈电点和电源连接，例如：通过一个带故障电流保护装置 (INF ≤ 30 mA) 的施工用配电器。建议使用电流为 30 mA 的 B 型 RCD (FI 开关)。

敷设电源线之前，必须排除可能存在的损坏情况。不得将混合器放到电源电缆上。

连接电流时，必须确保水不会流入插塞连接件中。仅允许使用装配有防水喷射的防护外壳的插塞连接件和接头。

- 不得使用不合适的或临时电源线。必要时，请咨询电气工人。

- 仅允许由专业人员对电气装备进行维修。对机器进行维护或维修作业之前，必须拔下电源插头。

- 电源线不得接触活动的和/或处于运动当中的机器部件，因为其可能会导致带电的金属部件损坏。

1.4 砂浆软管

仅使用标记了最小工作压力为 40 bar 的砂浆软管。



注意因喷射导致的受伤危险！磨损、扭结和使用不当可能会导致砂浆软管中形成泄漏点。液体可能通过泄漏部位射入皮肤。

每次使用前要彻底检查砂浆软管。

立即更换损坏的砂浆软管。

绝对不要自行修理损坏的砂浆软管！

避免严重弯曲或扭结，允许的最小弯曲半径为大约 80 cm。

车辆不得碾过砂浆软管，并要保护其不受锋利物体和棱边的影响。

绝对不要出于移动设备的原因牵拉砂浆软管。

不要扭转砂浆软管。

敷设砂浆软管的时候要确保不会有绊倒危险。



出于功能、安全和使用寿命方面的原因，仅使用 WAGNER 原装砂浆软管。



如果使用废旧的砂浆软管则会增加损坏的风险。Wagner 建议，必须在 6 年之后更换砂浆软管。

2 前言

2.1 可处理的材料

本预混机适合用于对以下材料进行通用混合：

- 含矿物的绝热复合系统 (WDVS) 粘合剂和钢筋
- 建筑粘合剂
- 约达 K 5 mm 的含矿物的纹理灰泥
- 石灰水泥灰泥
- 水泥灰泥
- 内墙石灰灰泥
- 石膏灰泥



其他喷涂材料只允许在咨询 WAGNER 应用技术部门后才可进行处理。

2.2 技术数据

电压:	220-230 V ~, 50-60 Hz
保险丝:	16 A 慢熔断
设备连接线:	6 m 长, 3 x 2.5 mm ²
最大功率:	3.4 kW
电机:	2.2 kW
水泵:	0.45 kW
压缩机:	0.75 kW
水接口:	3/4 "
水压 (最小) :	2.5 bar
混合功率 (标准值) :	15 l/min
最大工作压力:	40 bar
尺寸: 长 x 宽 x 高:	1450 x 685 x 1270 mm
装载高度:	1000 mm
最大粒径:	5 mm
料斗容积:	60 l
砂浆软管的最大长度:	
软管直径 25mm	20 m
软管直径 35mm	30 m
重量:	191 kg
防护等级:	IP 54
噪声级*:	
1 m 内的 L _{PA}	< 76 dB (A)
L _{WA}	90 dB (A)

* 本表格中混合器的噪声级反映的是操作人员耳朵听到的噪声等级 (1 m 内的 L_{PA})，声压级反映的是根据 EN ISO 3744 (2000/14/EC) 标准测得的环境噪音 (功率 L_{WA})。

2.5 设备上的操作元件和显示元件 (图 2)

- 1 总开关：开启 (I) 和关闭 (O) 机器
- 2 运行模式选择开关：
气动 (Pneumatic) = 使用气动喷枪进行操作
自动 (Automatic) = 使用自动喷枪进行操作
- 3 指示灯 (蓝色)：显示现存的电源电压
- 4 速度调节器 (+ 和 -)：在显示屏中显示选定的速度级 (1 至 4)
- 5 显示屏
- 6 输送泵选择开关：

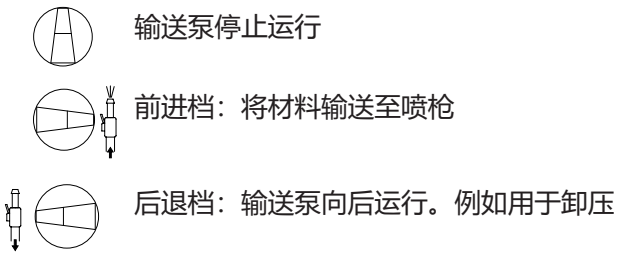

- 7 错误指示灯 (红色)：出现问题时亮起。此外，还会在显示屏中显示一个错误代码
- 8 水泵开/关开关：需要时开启水泵 (位置 I)
- 9 水泵指示灯 (绿色)：连接供水装置的泵已开启时亮起
- 10 供水系统：通过按压可手动或关闭供水系统
- 11 急停开关
按下急停开关，可立即关闭 PlastMax。
为了重新解除急停开关的锁定，必须旋转急停开关。
解除急停开关锁定后，机器仍然处于关闭状态。若要重新开启机器，则必须重新启动总开关。
- 12 水量调节器：通过旋转，可根据材料所需的水量调节水量
- 13 水流量计：显示设定的水量

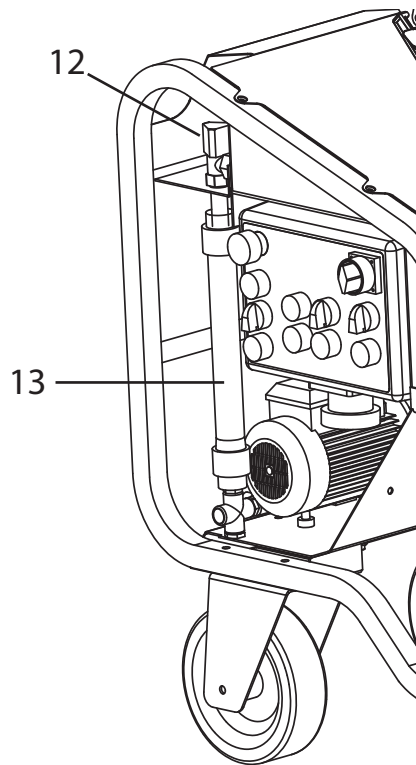
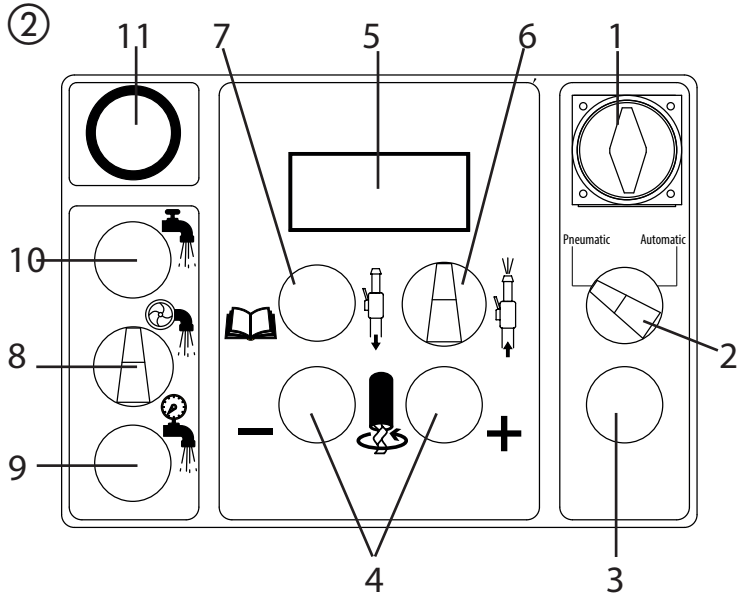

2.6 砂浆软管 (图 3)

- 1 材料接口 - 砂浆喷涂机
- 2 控制电缆接头/控制器 (仅自动版本的机器提供)
- 3 雾化空气接口 - 压缩空气气源
- 4 材料接口 - 喷枪
- 5 砂浆软管
- 6 雾化空气接口 - 喷枪
- 7 控制电缆接头/自动喷枪 (仅自动版本的机器提供)

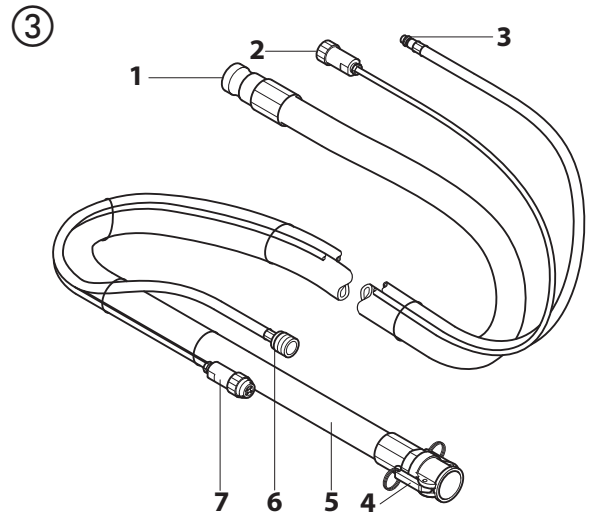

2.7 喷枪 (图 4)

- 1 材料接口
- 2 组合型材料和空气阀:
打开: 材料阀和喷枪呈 90°角度
已关闭: 材料阀朝前
- 3 石膏喷嘴:
石膏喷枪中可装入不同的石膏喷嘴。喷嘴大小视材料粘度和所需喷涂图案而定。
- 4 手柄:
手柄可以根据需要装在喷枪右侧或左侧。另外一侧的螺纹可以出于保护的目用任意堵头封闭。
- 5 控制电缆接头 (仅自动版本的机器提供)
- 6 空气量调节器
- 7 雾化空气接口

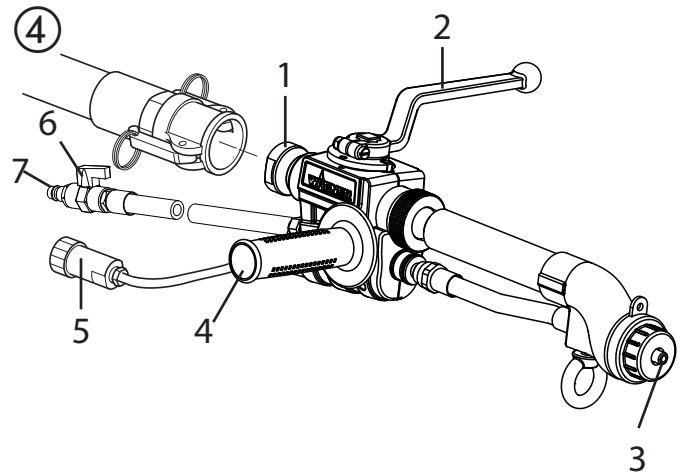

	<p>若要使用自动喷枪, 则需要一个性能更强的压缩机 (例如: C330/03附件)。</p>
--	---

3 运输



移动预混机之前，也应断开供水软管。
此外，料斗中的材料应尽量少。
松开制动器（图 5，1）。
将预混机推至所需方向。

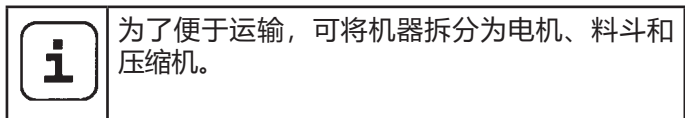
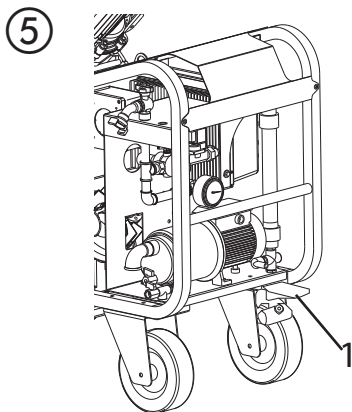

3.1 起重机运输

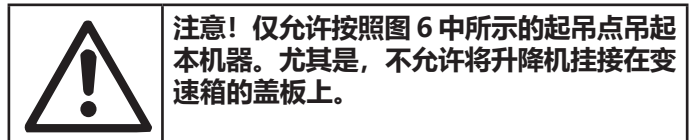
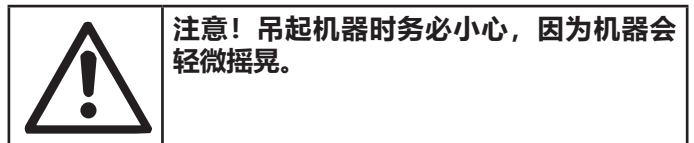
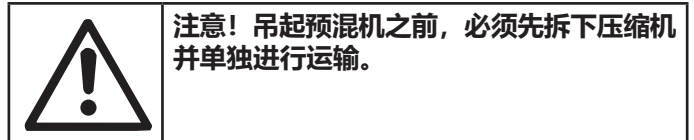
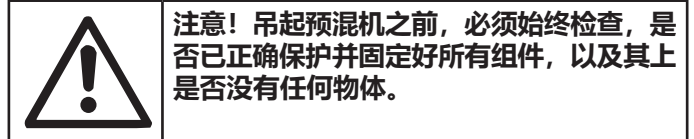

请使用适用于机器总重量 (191 kg) 的起重装置。
请使用为此设计的两个吊环（机器每侧一个）吊起机器（如下图所示）。

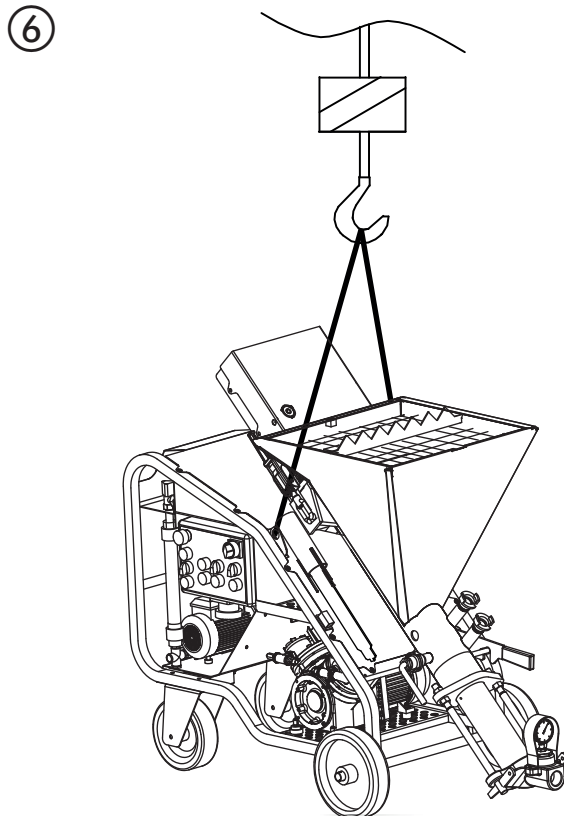

4 安装

将预混机平稳地安放到工作位置，使其无论是在作业期间还是在随后的清洁过程中都不会遇到障碍，并且能够保持软管长度尽量短。

- 通过制动器刹住滚轮。
- 安放混合器时，必须确保液体（如雨水）无法进入料斗中。

4.1 电源连接

	请检查，供电电压、电网频率和电流连接（插座、保险丝、电缆）与功率牌上的说明是否一致。
---	---

必须已对电源线进行了防过电流保护（例如通过保险丝和热磁脱扣保护开关）和防间接接触保护（例如通过故障电流保护开关）。为了避免电压过度下降，测量供电电缆的尺寸时必须考虑工作电流和电源线的长度。

	注意！只允许使用横截面积为 3x2.5 mm² 的延长电缆。不得使用电缆绞盘。
--	---

供电电缆必须能够频繁移动，而且装有耐磨护套（例如：H07RN-F）。

将混合器连接到电网之前必须确保，所有安全防护装置均已正确放置好并且处于完好的使用状态。请检查，延长电缆是否处于完好状态以及插座和插头是否干燥。

将供电电缆（图 7，1）连接到混合器仪表板的插头上。将电源插头插入插座中。仪表板上的蓝色指示灯（图 7，2）亮起。

若指示灯熄灭，则表示不存在电压或电压超过了 240 V。

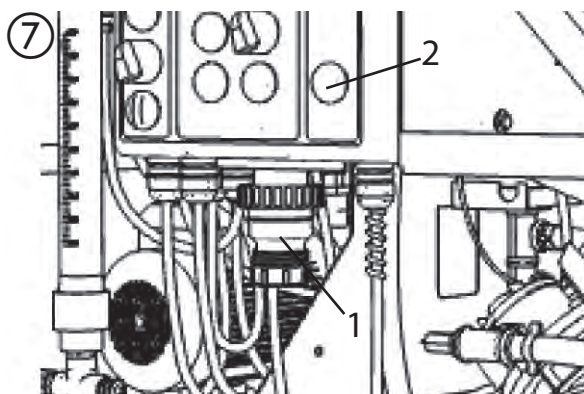

4.2 水源连接

请将水接口（图 8，1）连接到供水管网。

	供水管网必须确保流量最低为 15 升/分钟，压力最小为 2.5 巴。
---	---

如果供水不足，那么也可使用一个装有洁净水的约 200 升的大型储水器（运行期间必须始终处于装满状态）。请将一根最长为 3 米且在运行期间不会变形的软管（最小直径为 3/4 "，最好底部带过滤器）连接到增压泵（图 8，1）。

	重要提示！首次连接到储水器时以及每次排空供水设备后或机器停机较长时间后，必须手动给吸料软管加水，从而将泵投入运行。
---	--

请将软管连接到储水器。

请将泵的开/关开关（图 8，2）调至 I 位置，绿色指示灯（3）亮起。

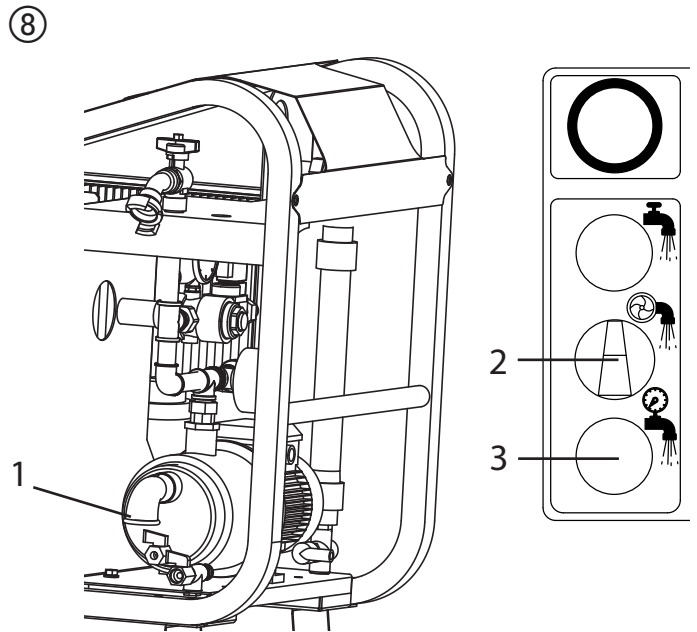

4.3 连接砂浆软管

将砂浆软管 (图 9, 3) 连接到材料出口, 并使用拉紧杆 (4) 进行固定。

使用带快速连接器的空气软管时: 将随附的适配器 (7) 安装到空气接口 (8) 上。

将砂浆软管上的雾化空气接口 (6) 连接到适配器 (7) 或空气接口 (8) 上。

使用自动版本时: 将远程操作装置拧到接口 (5) 上。

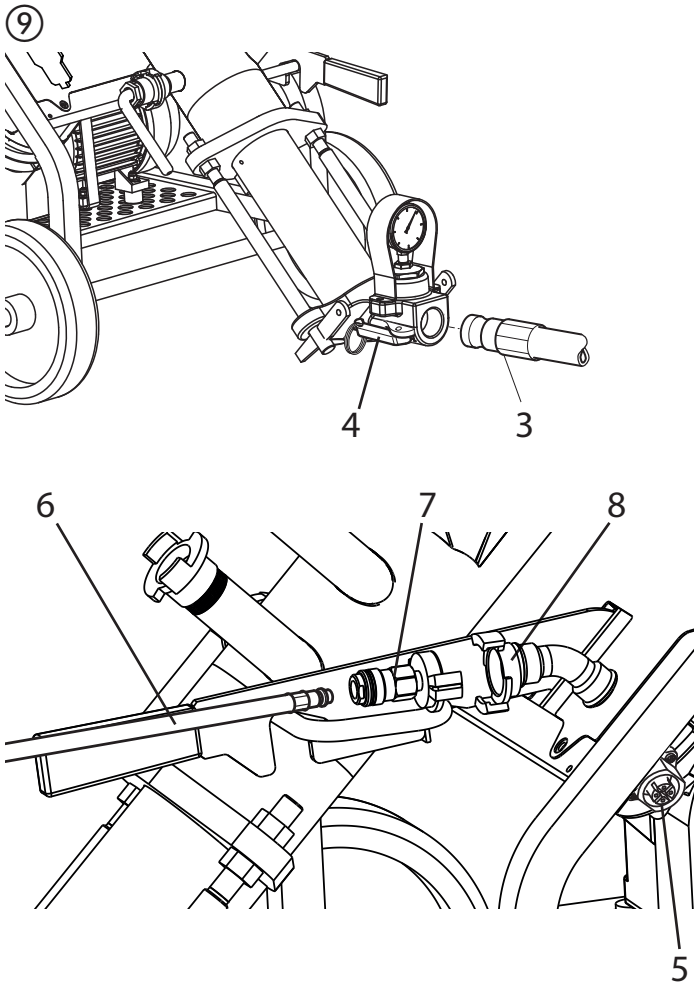

4.4 连接喷枪 (图 10)



在附件中提供有不同尺寸的喷嘴。喷嘴直径越小, 雾化越精细。直径较大的喷嘴适用于粗粒材料 (喷嘴尺寸应至少为粒径的三倍, 例如: 粒径 \rightarrow 3 mm / 喷嘴尺寸 \rightarrow 10 mm)

请选择适用于此材料的石膏喷嘴:



在此请注意, 气孔必须畅通。需要时, 请使用清洁用通针 (0342 916) 进行清洁。

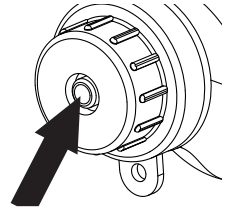

将石膏喷嘴 (图 10, 3) 放到石膏喷枪上。



将石膏喷枪 (1) 连接到材料软管, 并用拉紧杆 (8) 进行固定。

将雾化空气接口 (7) 连接到砂浆软管的空气软管上。

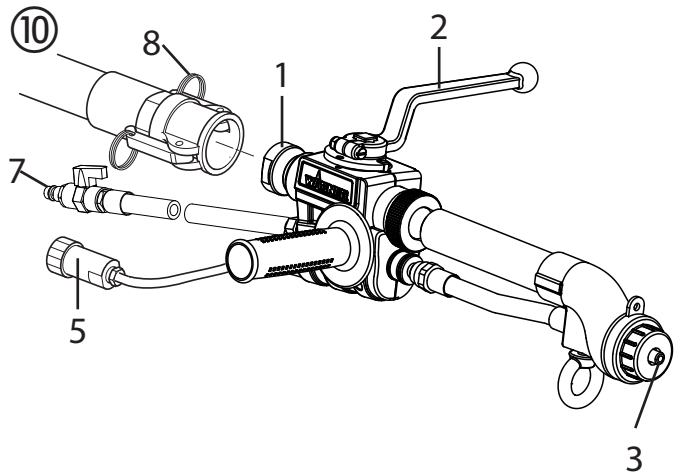
使用自动版本时: 将远程操作装置的控制插头 (5) 拧到砂浆软管的控制电缆上。



5 投入使用

	<p>防护格栅必须已安装并正确固定好。移除防护格栅会导致活动的机器部件停止运行。若要重新运行机器，则必须重新装入防护格栅，并将总开关旋转到 0 位置。</p>
	<p>在料斗中仅允许加注合适的干粉材料或预先混合好的材料。</p>

5.1 干粉材料

	<p>为了避免堵塞，应对砂浆软管进行预冲洗。注意！水不足以代替润滑剂。使用纤维素胶（例如：Metylan 墙壁喷胶，商品编号 2312136）。</p>
---	--

将运行模式选择开关（图 11，19）调至气动（对应气动喷枪）或自动（对应自动喷枪）位置。
 在砂浆软管中灌入纤维素胶，将砂浆软管连接到材料出口，并使用拉紧杆（4）进行固定。
 移除接口处的水软管（17）和盲塞（18）。
 通过前后移动清洁工具（12）移除剩余材料。然后，从开口中完全拉出清洁工具。

	<p>视材料而定，应将水软管（17）安装到其它接口上： 容易混合的材料 = 下方接口 较难混合的材料 = 上方接口</p>
---	---

需要时，移除盲塞（18）并连接水软管（17）。
 按下并按住供水系统按键（9），直至清洁工具的开口处有水流出。
 重新装入并正确锁闭清洁工具。
 将料袋中的材料装入料斗中。（图 13）。
 使用水量调节器（13）调节流量计（图 11，14）上所示的水流量：
 - 为水泥基材料时 -> 300 升/小时
 - 为石膏基材料时 -> 500 升/小时
 将仪表板上的总开关（图 11，1）旋转到 1 位置，开启压缩机。
 操作这两个按键（图 11，3），直至显示屏（4）上显示操作档位 2 或 3。
 将启动开关（图 11，5）旋转到工作位置（向右）。
 将喷枪放在空桶上方。
 关闭空气量调节器（图 12，15）。
 打开喷枪上的材料阀（图 12，16）（材料阀和喷枪呈 90° 角度）。
 纤维素胶从喷嘴中流出时，关闭材料阀（图 12，16）（材料阀指向前方）。
 此时，机器已准备就绪。

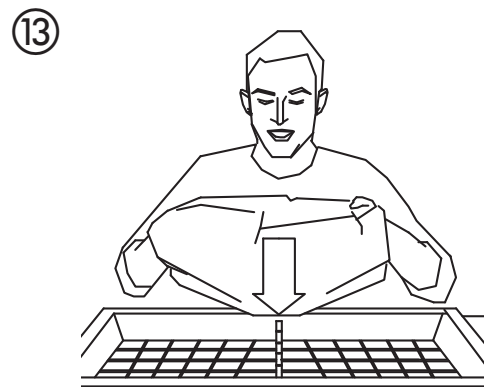
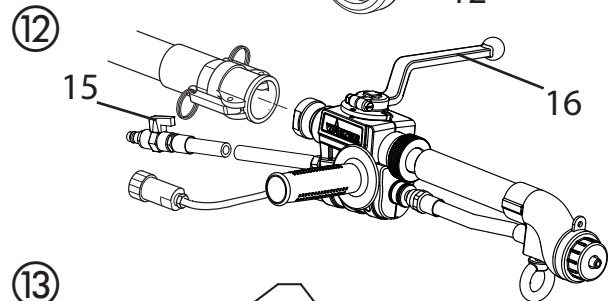
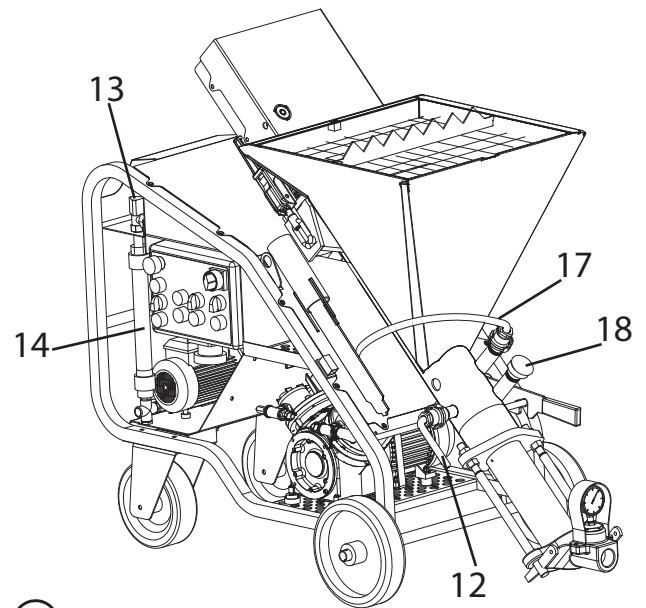
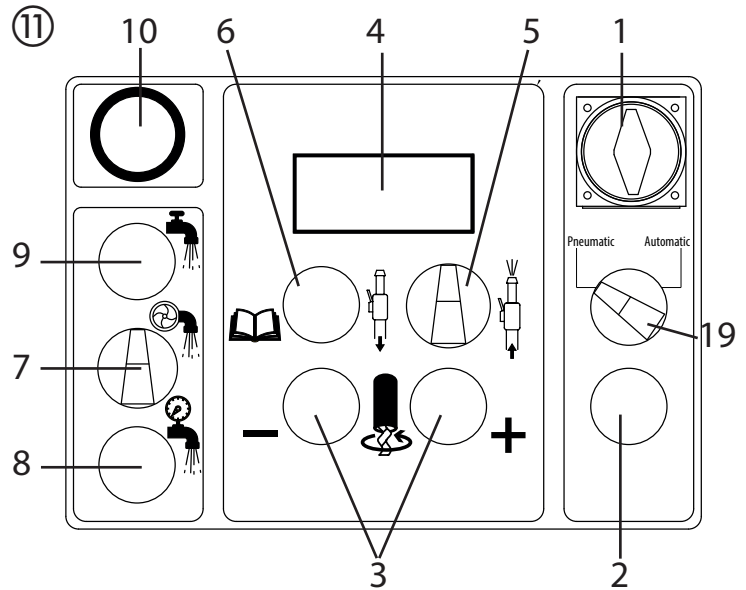

5.2 预先混合的材料



为了避免堵塞，应对砂浆软管进行预冲洗。
注意！水不足以代替润滑剂。使用纤维素胶（例如：Metylan 墙壁喷胶，商品编号 2312136）。

将运行模式选择开关（图 11，19）调至气动（对应气动喷枪）或自动（对应自动喷枪）位置。

在砂浆软管中灌入纤维素胶，将砂浆软管连接到材料出口，并使用拉紧杆（4）进行固定。

向料斗中加注预先混合的材料。

将仪表板上的总开关（图 11，1）旋转到 1 位置，开启压缩机。

按下这两个按键（图 11，3），直至显示屏（4）上显示操作档位 2 或 3。

将启动开关（图 11，5）旋转到工作位置（向右）。

将喷枪放在空桶上方。

关闭空气量调节器（图 12，15）。

打开喷枪上的材料阀（图 12，16）（材料阀和喷枪呈 90° 角度）。



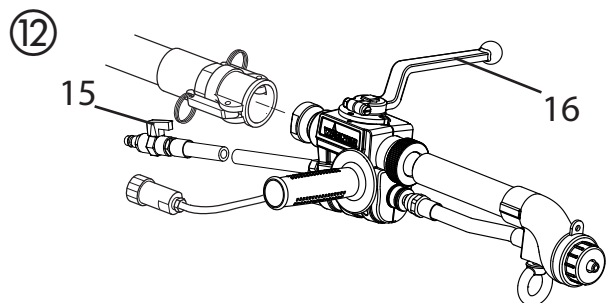
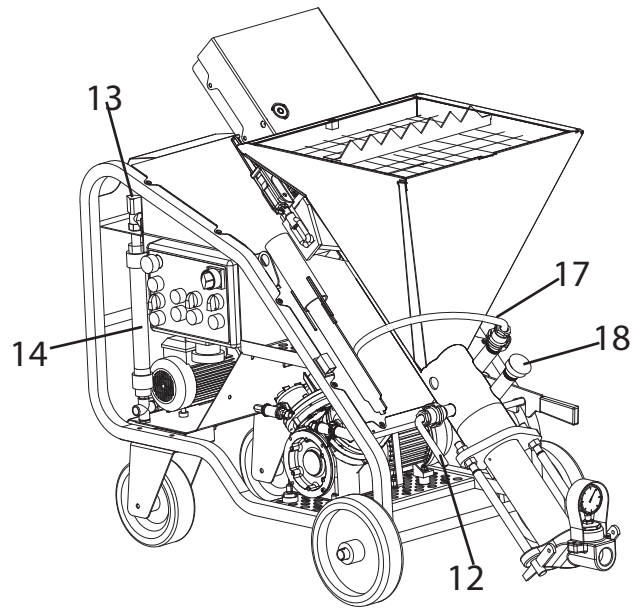
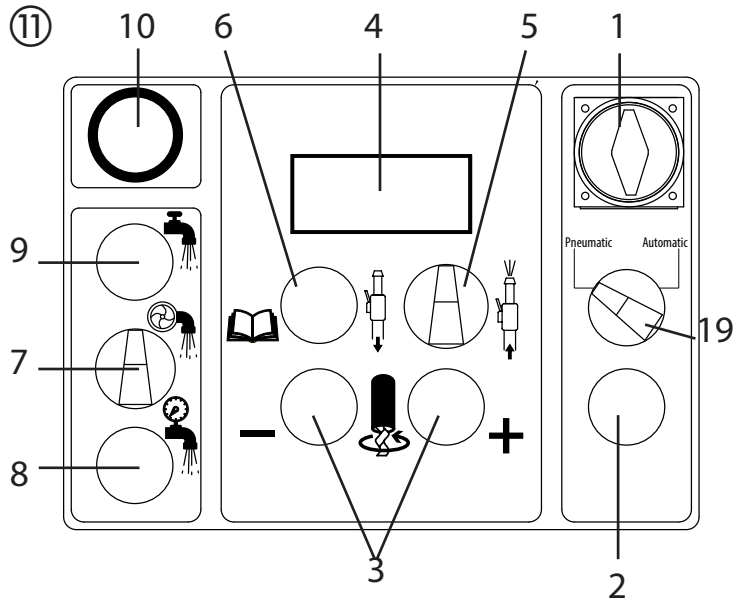

纤维素胶从喷嘴中流出时，关闭材料阀

（图 12，16）（材料阀指向前方）。

此时，机器已准备就绪。







6 使用

	防护格栅必须已安装并正确固定好。移除防护格栅会导致活动的机器部件停止运行。若要重新运行机器，则必须重新装入防护格栅，并将总开关旋转到 0 位置。
	进行作业之前，必须穿戴规定的个人防护装备。
	紧急情况下可通过按下红色的急停开关中断机器运行，从而停止所有活动部件。然后拔出电源插头。
	通过一个温度开关对电动机进行了防过载保护。必须等到冷却后，才能通过开关重新开启预混机。

打开喷枪上的空气量调节器（图 12, 15）和材料阀（图 12, 16）。

材料量需要通过控制单元的输送量调节器（图 11, 3），空气量则需要通过空气量调节器（图 12, 15）根据喷涂图案进行相应的调节。

	重要：处理干粉材料期间不得中断供水系统。如果没有水流入，机器则会停止。重新启用机器之前，必须查明出现问题的原因：阀已关闭、供给软管扭结、水箱已空、过滤器堵塞。
	从喷枪中流出的混合物可通过修正水量进行优化。为此，可通过水量调节器（图 11, 13）以 20 升为一档更改水流量，直至达到所需的浓度。
	材料阀磨损严重。无法通过材料阀调节材料量，只能通过输送量调节器进行调节。
	若在作业期间发生断电情况，则必须尽快冲洗机器和软管。还需拆下泵，从胶套中旋出螺杆并进行清洗。然后，组装好所有组件。

6.1 更换胶套

	注意！进行拆卸之前，必须确保没有剩余压力。注意压力表 —> 0 bar。关闭机器并拔下电源插头。
---	--

移除出口单元上的开口销。
拔下出口单元和胶套。
安装所需的胶套（附件）。

6.2 工作间歇

注意材料的硬化时间。
停机时间过长可能会导致材料软管堵塞：
在此情况下，材料将无法从喷枪中流出，压力表上则显示一个高于正常工作压力的压力。
将总开关旋转到 0 位置，关闭机器。
找出软管堵塞位置，然后使用锤子进行敲打，以便将材料从中移除。

	注意！如果必须取下喷枪或打开管路接口，那么事先必须确保其内部不存在压力。使机器短暂（最长 5 秒钟）向后运行，以便卸除压力。材料压力表必须显示 0 bar，并且软管必须柔软（除了可能堵塞的位置外）。进行此操作的操作人员必须受过相关的专业培训。即使只是怀疑料管中略微存在剩余压力，也绝不允许打开接口。
--	---

7 机器的清洁和关闭

作业结束后继续进行泵送，直至料斗和材料软管排空为止。



注意！移除喷枪或软管之前，必须始终确保其中不存在残余压力。注意压力表 → 0 bar。

使机器向后运行，以便卸除压力。

将总开关旋转到 0 位置，关闭机器。

移除石膏喷枪，并按照如下所述对其进行清洁：

- 清洁石膏喷嘴（图 14，1）。
- 使用清洁用通针清洁气孔
- 清洁 O 型环（图 14，2），并在其上涂抹润滑脂。
- 用瓶刷（0 3 4 2 3 2 9）清洁喷枪和材料管。
- 彻底清洁所有螺纹。
- 用清水彻底冲洗喷枪。

打开和关闭材料阀三次。

将砂浆软管和出口单元脱开连接。

将清洁球插入砂浆软管中。

将砂浆软管连接到清洁接口（图 15，3）。

开启水泵，并打开水阀，直至清洁球从另一端流出。

反复进行此过程，直至软管完全洁净为止。

松开带保险装置的快速连接件，并打开料斗的混合室。（图 16）

取出并清洗混合器（图 16，1）。

使用刮铲清洁混合区域。

装入清洁工具，并将清洁工具挂接到连接变速箱的接口处。

（图 17）

开启机器，直至清洁过程结束。

停止机器，并重新取出清洁工具。

重新装入洁净的混合器。

清洁完机器后关闭总开关，从插座中拔下电源电缆，关闭注

水口，打开外加水阀几秒钟，然后断开供给软管。

即使只存在极低的冻结危险，也必须打开供水设备中的四个阀（图 18），将供水设备中的水全部排出。

机器重新投入使用之前，必须重新关闭这些阀。

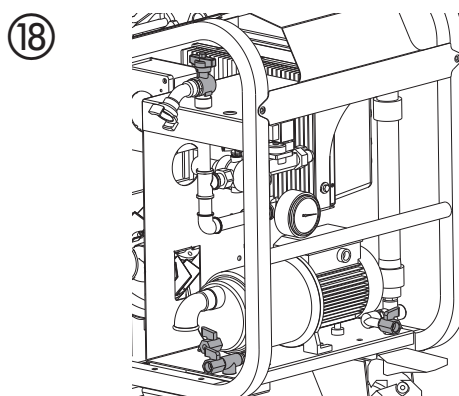
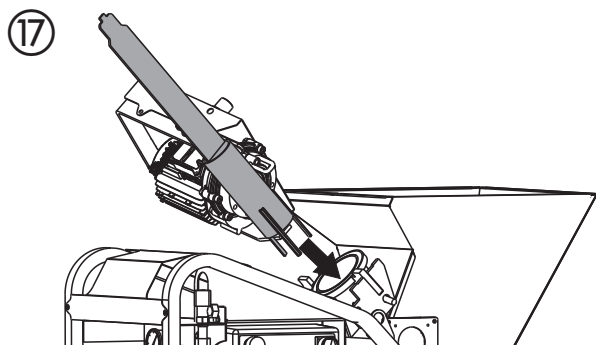
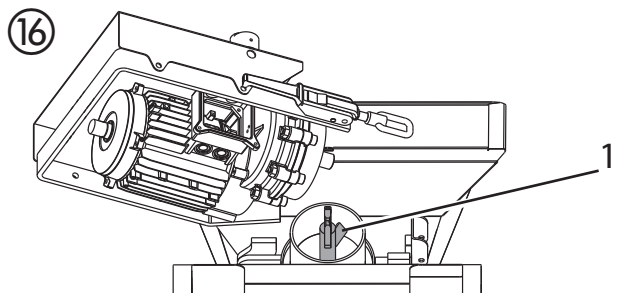
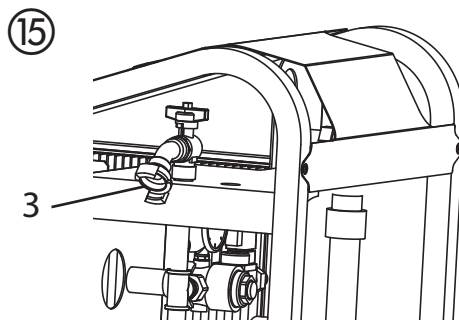
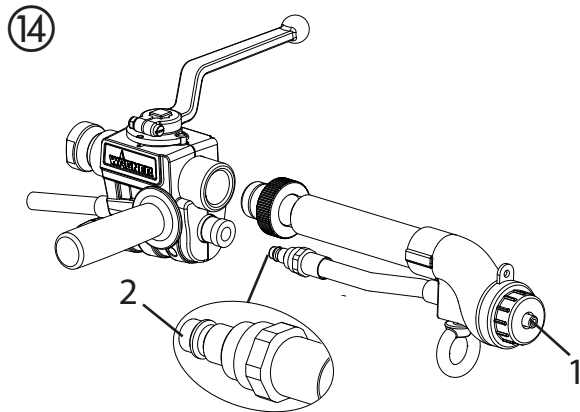

8 维护

	维护作业仅允许由专业人员进行。事先必须关闭机器，拔下电源插头并排空料斗。
---	---

每天检查一次水过滤器 (图 19, 1) 是否洁净。
 每周检查一次压缩机空气滤清器 (图 19, 2) 是否洁净。如果其磨损或损坏, 请予以更换。
 每周检查一次混合器是否处于完好无损的状态, 并在必要时进行更换。
 每周检查一次电机接口是否处于完好无损的状态, 并在必要时进行更换。
 每周检查一次电机是否无尘且没有污物, 并在必要时使用压缩空气进行清洁。
 每周检查一次插头与插座的接触位置是否完好无损、洁净、干燥且未生锈。
 请经授权的 Wagner 客户服务部门每 12 个月对机器进行一次检查。

	必须按照规定将废油视作特殊垃圾进行废弃处理。
---	-------------------------------

	在此请注意, 机器标牌和贴牌必须始终处于可读状态。
---	----------------------------------

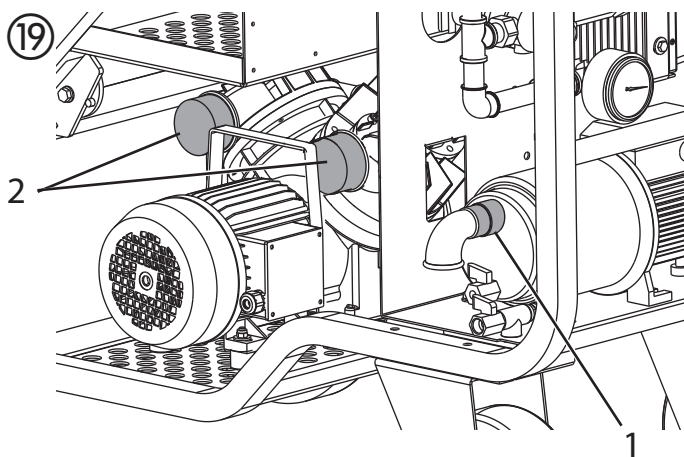

9 维修

	进行维修作业期间, 不得运行预混机。仅允许由专业人员对电气装备进行维修。需要时, 仅允许使用 Wagner 的原厂备件, 并且不得对其进行任何改动。
---	---

	如果在进行维修作业时取下了防护盖板, 那么之后必须重新将其正确安装好。
---	--

硬材料和软材料交替流出, 可能是泵磨损的迹象。若要更换胶套/转子, 则请进行如下操作:

	注意! 进行拆卸之前, 必须确保没有剩余压力。注意压力表 —> 0 bar。关闭机器并拔下电源插头。
---	--

松开料斗左侧的把手。
 将管扳手放到混合器端部, 然后转动管扳手, 直至能够将螺杆从胶套内部取出。
 重新关闭把手, 使整个料斗单元倾斜并卡入已升起的位置中, 拆除材料总管道, 然后安装一对新的螺杆/胶套。
 在将螺杆安装到胶套中之前, 请使用在 Wagner 处购得的润滑剂喷涂螺纹件。在此不得使用矿物油或矿物油脂, 因为由此可能会损坏胶套。避免使用所有苯类物质。

10 故障排除

10.1 显示屏中的错误信息

	运行期间发生故障时，会在显示屏中显示以下错误信息。
--	---------------------------

显示屏中的错误信息	可能原因	排除
ERR00	<ul style="list-style-type: none"> - 防护格栅缺失或未处于正确位置 - 螺杆泵电机中的温度监控器 (参见 ERR02) - 已按下急停开关 - 系统故障 	<ul style="list-style-type: none"> - 检查，格栅是否处于正确位置 - 重新启动之前，等待冷却 - 重新启动之前，等待冷却 - 联系 Wagner 服务部门
ERR01	<ul style="list-style-type: none"> - 电子线路板 (逆变器) 高温 	<ul style="list-style-type: none"> - 重新启动之前，等待冷却
ERR02	<ul style="list-style-type: none"> - 螺杆泵电机高温 - 电机已过载较长时间。 	<ul style="list-style-type: none"> - 重新启动之前，等待冷却。 - 修正所用的混合物
ERR03	<ul style="list-style-type: none"> - 螺杆泵的电机过载 (电机卡住) 	<ul style="list-style-type: none"> - 向混合物中加水 - 向混合物中添加粘结剂 - 使用粒径分布最佳的沙子。 - 移除堵塞物。
ERR04	<ul style="list-style-type: none"> - 螺杆泵的电机旋转，但是已过载 	<ul style="list-style-type: none"> - 使用粒径分布最佳的沙子。 - 向混合物中加水 - 向混合物中添加粘结剂 - 降低螺杆泵电机的转速 - 确保机器运行时的供电电压处于 200 和 230 伏之间，确保已对供电电缆进行正确测量，并确保没有其他设备 (起重机、升降设备、锯床、混凝土混合机等) 连接在同一条供电线路上
ERR05	<ul style="list-style-type: none"> - 虽然喷枪上的空气阀已关闭，但是压缩机开关过于频繁 - 空气软管中有孔洞 - 接口上有泄漏点 	<ul style="list-style-type: none"> - 更换喷枪 - 更换空气软管 - 检查接口
ERR06	<ul style="list-style-type: none"> - 当前供电电压高于 265 伏 	<ul style="list-style-type: none"> - 请专业人员检查电源输出端的电源。
ERR07	<ul style="list-style-type: none"> - 由于接地或系统故障造成电流损失 	<ul style="list-style-type: none"> - 联系 Wagner 服务部门 - 检查，是否有水进入系统中
ERR08	<ul style="list-style-type: none"> - 供电电压过低 (低于 170 伏) 	<ul style="list-style-type: none"> - 确保机器运行时的供电电压处于 200 和 230 伏之间，确保已对供电电缆进行正确测量，并确保没有其他设备 (起重机、升降设备、锯床、混凝土混合机等) 连接在同一条供电线路上
BLOC	<ul style="list-style-type: none"> - 螺杆泵的电机卡住 	<ul style="list-style-type: none"> - 检查，胶套和螺杆是否相互楔入 (拆除并释放/更换) - 移除料斗/混合室中的异物

显示屏中的错误信息	可能原因	排除
STOP	<ul style="list-style-type: none"> - 已关闭喷枪的空气警告信息。 - 喷枪嘴 / 空气管道堵塞, 机器在暂停结束后未启动。 	<ul style="list-style-type: none"> - 打开喷枪 - 清洁空气喷嘴或释放空气管道
H2O	<ul style="list-style-type: none"> - 水压低于 2.5 bar; 流量/压力不足以确保正确运行 - 机器自动关闭并重启, 显示屏上闪烁显示 H2O 几秒钟之久。 - 管路/设备中有空气 - 自动喷枪已关闭 	<ul style="list-style-type: none"> - 开启机器的水泵 - 检查, 机器液压设备中的过滤器是否洁净 - 使水从排放阀中流出, 以便对管路/设备进行排气 - 不存在错误

10.2 其它可能发生的错误

故障	可能原因	排除
机器不启动	<p>水</p> <ul style="list-style-type: none"> - 水压过低：压力表上所示的压力低于 2 bar（绿色指示灯亮起？），显示屏上显示 H2O <p>材料</p> <ul style="list-style-type: none"> - 混合室中的产品过于干燥（砂浆泵卡住？红色指示灯亮起？） <p>空气</p> <ul style="list-style-type: none"> - 喷枪阀完全打开后，气压未下降到机器压力开关的最低压力值以下 <p>格栅</p> <ul style="list-style-type: none"> - 格栅安装不正确，显示屏上显示 Bloc <p>控制器</p> <ul style="list-style-type: none"> - 未插入控制电缆（自动模式下） - 在气动模式下将控制器设为了“自动” - 在自动模式下将控制器设为了“气动” 	<ul style="list-style-type: none"> - 检查，供给管路中是否有水流出 - 检查，水过滤器是否洁净 - 检查，水泵是否已开启 - 如果泵要从存储器中获取水，则请检查，首次是否对其进行了正确加注，并确保接口不存在泄漏情况 - 机器首次启动不正确（参见第 5 章） - 水流量设置的过小（参见第 4.2 章） - 没有水注入混合室（注水口堵塞，水磁阀失灵） - 检查，空气软管是否扭结或堵塞 - 检查，喷嘴是否完好无损且洁净 - 正确安装格栅 - 插入控制电缆（参见第 4.2 章） - 切换为“气动” - 切换为“自动”
机器和压缩机均不启动，并且蓝色指示灯保持关闭状态	<ul style="list-style-type: none"> - 施工现场仪表板的插座上无电流（保险丝？） - 无电流输送到机器（插座接口损坏？电缆中断？） - 总开关未开启 	<ul style="list-style-type: none"> - 检查相邻列示的各项
机器不启动，压缩机启动	<ul style="list-style-type: none"> - 未按下操作开关 - 启动时对应最小水压的压力开关作出响应（水泵已开启？参见“机器不启动”，水原因） 	<ul style="list-style-type: none"> - 检查相邻列示的各项
机器和/或压缩机未停止	<ul style="list-style-type: none"> - 空气软管损坏（软管被截断？接口处有空气逸出？） - 压缩机生成的压缩空气不足 - 喷枪上的空气阀损坏（在打开位置卡住） - 压力开关损坏 	<ul style="list-style-type: none"> - 检查空气软管，尤其是螺纹连接件，必要时进行更换 - 检查空气滤清器（参见第 8 章） - 更换喷枪 - 联系 Wagner 服务部门
机器在启用后停止运行	<ul style="list-style-type: none"> - 吸入式过滤器堵塞 - 减压器的过滤器堵塞 - 水软管过长和/或过细 - 水供应不足 	<ul style="list-style-type: none"> - 检查相邻列示的各项：清洁过滤器，并检查水软管的水流量是否充足（石灰/水泥砂浆至少为 10-12 升/分钟，石膏砂浆至少为 15-20 升/分钟）。必要时更换软管或从附加的水箱中取水

故障	可能原因	排除
材料流中断 (气泡)	<ul style="list-style-type: none"> - 混合器不适合用于本产品 - 材料粘住混合室 	<ul style="list-style-type: none"> - 清洁混合器, 必要时更换为适用于此产品的混合器 - 清洁混合室并使其干燥, 然后重新投入使用
材料流中断	<ul style="list-style-type: none"> - 材料软管堵塞 - 喷枪堵塞 	<ul style="list-style-type: none"> - 排除堵塞情况
喷枪上的材料不恒定、过硬或过稀	材料预先混合不佳 螺杆胶套组件损坏 混合器不适用或已损坏	<ul style="list-style-type: none"> - 检查相邻列示的各项
运行期间混合室中的水量增加	<ul style="list-style-type: none"> - 螺杆胶套组件损坏 	<ul style="list-style-type: none"> - 更换螺杆胶套
机器停止时混合室中的水量增加	<ul style="list-style-type: none"> - 电磁阀损坏 	<ul style="list-style-type: none"> - 检查

11 附件

位置	订购编号	名称	位置	订购编号	名称
1	2370 170	自动喷枪*	11		砂浆软管 (包括空气软管) , 用于气动喷枪 (2334122)
2	2334 121	石膏喷枪 (自动版本机器)	2324 927		砂浆软管 DN 19 – 2 m, 接口 V 25, 带旋转接头
3	2334 122	石膏喷枪 (气动版本机器)	2325 194		砂浆软管 DN 19 – 10 m, 接口 V 25
4		自动喷枪纹理喷嘴:	2325 182		砂浆软管 DN 25– 10 m, 接口 V 25
	0268 779	纹理喷嘴 4	2363 405		砂浆软管 DN 35– 13.3 m, 接口 V 35
	0348 915	纹理喷嘴 5	12	2337 672	弯枪头
	0268 780	纹理喷嘴 6	13	0342 916	清洁用通针
	0348 916	纹理喷嘴 7	14	0342 330	清洁球, 用于 DN 19
	0268 781	纹理喷嘴 8		0342 331	清洁球, 用于 DN 27
	0348 917	纹理喷嘴 9		0342 332	清洁球, 用于 DN 35
	0268 782	纹理喷嘴 10	15	0342 329	瓶刷, 用于内部清洁 出口单元和喷枪
	0342 327	纹理喷嘴 12	16	9100 095	带手柄的刷子和保护盖 (无图片)
	0342 328	纹理喷嘴 15	17	0348 959	清洁刷 (280-420 mm 长, 无图 片)
	0268 905	纹理喷嘴套件 4、6、8、10	18	0348 450	工具箱 (内无工具)
5	2362 235	石膏喷嘴 10	19	9992 824	泵润滑剂 500 ml
	2362 236	石膏喷嘴 12	20	0342 215	喷管支架
	0268 746	石膏喷嘴 14	21	0342 241	清洁适配器 M 27 – GK
	0268 747	石膏喷嘴 16		0348 948	清洁适配器 M 35 – GK
	0268 748	石膏喷嘴 18	22	2337 718	压缩机 C330/03, 230 V~, 50 Hz,
	0268 726	石膏喷嘴套件 14、16、18	23	2349 514	水软管 (无图片)
6	2334 123	加长杆 80 cm	24	2311 644	空气软管 (无图片)
	2339 400	加长杆 150 cm	25	0342 321	连接器减径管件 V35/M25 (无图 片)
	2334 124	加长杆 200 cm		0348 920	连接器减径管件 V25/M35 (无图 片)
7	2335 394	打胶枪头	26	2311 692	自动喷枪的控制电缆 14m (无图 片)
8	2335 388	挤胶枪头	27	2312 136	砂浆软管的润滑剂 (Metylan 墙壁 喷胶) 125 g (无图片)
9		砂浆软管 (包括空气软管和控制电缆), 用于自 动喷枪 (2334115, 2334121)			
	2334 131	砂浆软管 DN 19 – 2 m, 接口 V 25, 带旋转接头			
	2325 193	砂浆软管 DN 19 – 10 m, 接口 V 25			
	2325 197	砂浆软管 DN 25 – 10 m, 接口 V 25			
	2363 405	砂浆软管 DN 35 – 13.3 m, 接口 V 35			
10	0342 314	固定联轴器 M 27 的密封件			

* 若要使用自动喷枪, 则需要一个性能更强的压缩机 (例如: C330/03, 附件位置 22)。

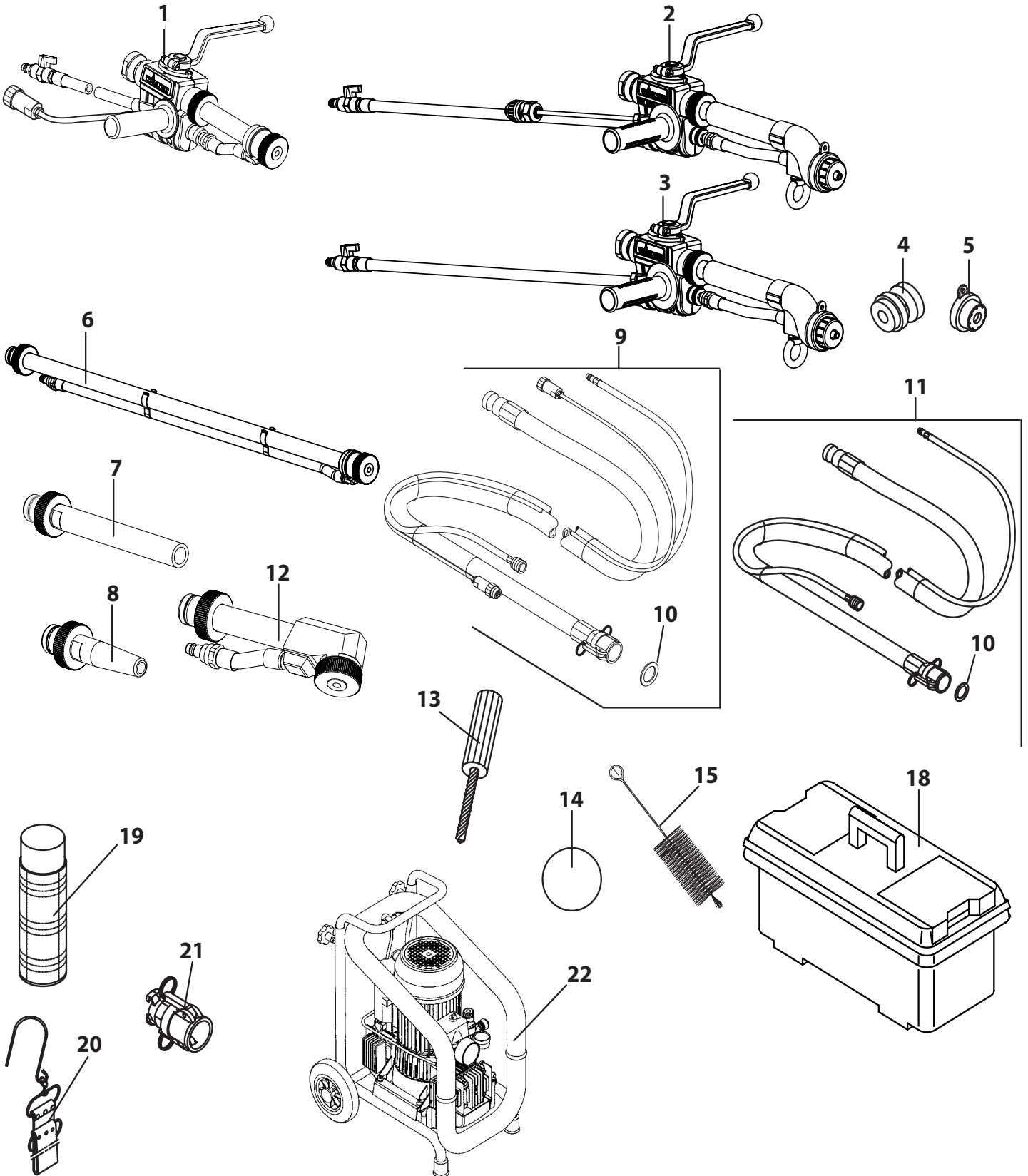

12 备件清单

位置	订购编号	名称	位置	订购编号	名称
1	2367367	料斗	35	2367440	全套后轮
2	2367368	全套安全格栅	36	2367452	拉杆
3	2367369	快速接头	37	2367453	电机
4	2367370	接管	38	2367454	支架
5	2367371	减震器	39	2367455	全套外壳
6	2366671	螺杆	40	2367456	密封件
7	2366670	胶套	41	2367457	传感器
8	2367382	压力表	42	2367450	螺母
9	2367383	材料接口	43	2370814	垫圈
10	2367384	出口单元套件	44	2370819	支架
11	2367385	控制箱	45	2370815	螺栓
12	2367386	扁平吊钩	46	2370817	垫圈
13	2367388	开口销	47	2370818	螺栓
14	2367389	法兰螺母	48	2406918	水流量计
15	2367390	清洁工具			
16	2367391	全套压缩机			
17	2367421	压缩机过滤器			
18	2367422	刮刀			
19	2367423	缓冲器			
20	2367428	缓冲器			
21	2367430	混合器			
22	2367434	夹具			
23	2367436	间隔垫片			
24	2367438	前轮			
25	2368772	全套后轮 (包括制动器)			
26	2349166	电源线			
27	2367441	清洁用通针			
28	2367442	专用扳手			
29	2367443	水泵过滤器			
30	2367444	压力表			
31	2367445	压力表			
32	2367446	快速连接器			
33	2367447	球阀			
34	2367448	全套供水设备			

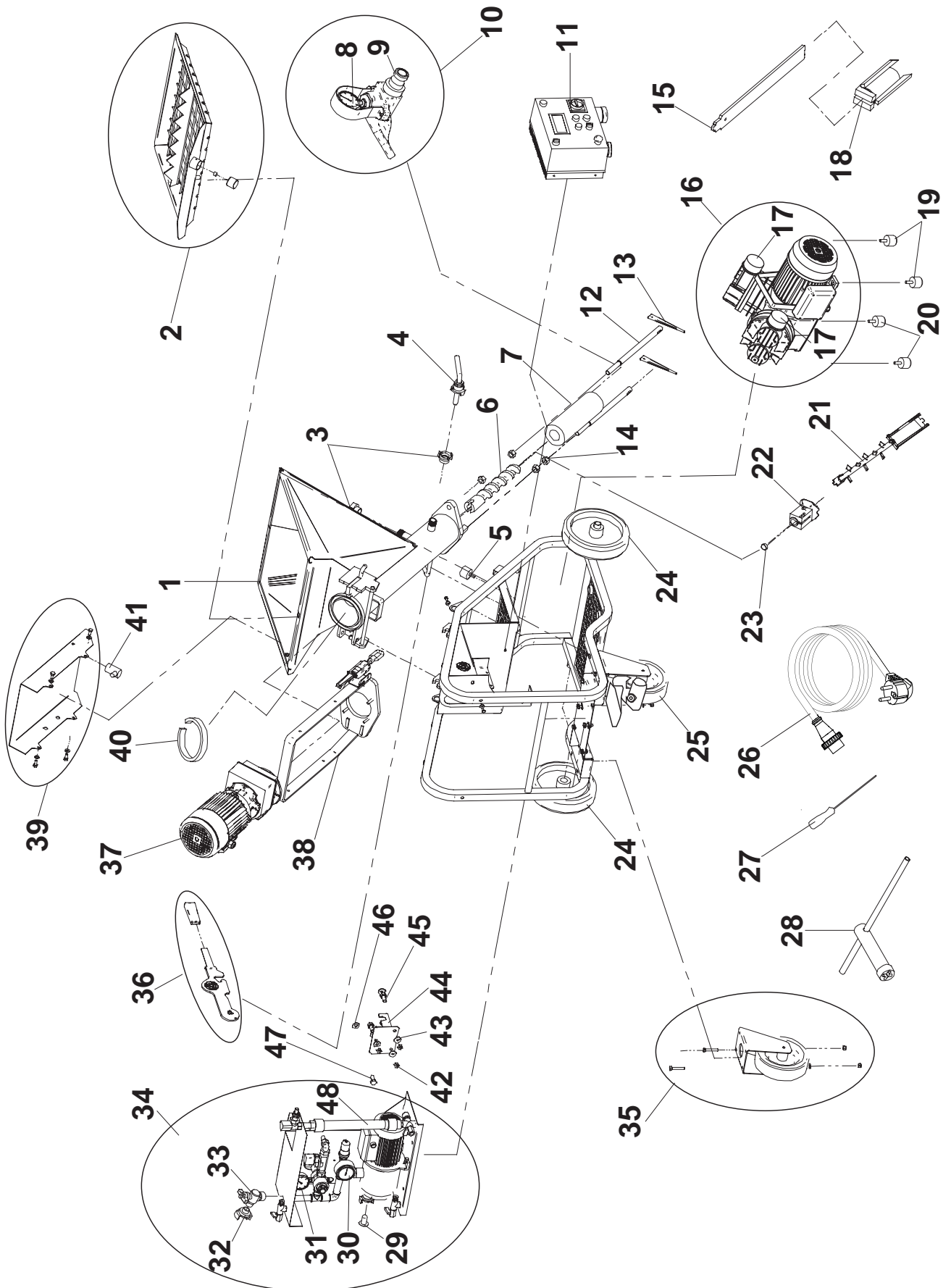

设备试验

为了安全，建议至少每12个月，按照规定，由专业人员对设备进行检查，确保设备能继续安全运行。

如设备没有使用，可推迟检查周期。

同时必须遵循所有（可能有所差异）国家检验和维护法规的规定。

如有问题，请联系瓦格纳尔的客户团队。

产品责任方面的重要信息

1990年1月1日起生效的欧盟指令规定，只有在所有零部件均由制造商制造或批准，且设备正确安装和操作的条件下，制造商方对其产品承担质量责任。

如采用第三方可选件或备件，制造商将免责或仅部分承担责任。在极端情况下，主管部门可能禁止全套设备的使用（德国工业雇主责任保险协会和工厂检查员）。

只有使用瓦格纳尔原装配件和备件方可确保安全运转。

处置说明

遵循废弃电气和电子设备方面的2002/96/EC号欧盟指令和按照国家法律的规定实施时，本产品不得随生活垃圾一起处置，必须以环保方式进行回收利用！



瓦格纳尔建筑涂装标准质保条款

(自2017年8月1日起生效)

该质保承诺适用于2017年8月1日以后在瓦格纳尔中国及瓦格纳尔中国授权经销商处购买的所有专业建筑涂装设备。

标准质保条款

1. 质保范围

所有瓦格纳尔建筑涂装设备（下文简称为“产品”）都严格按照瓦格纳尔质保要求经过了认真检验、测试和验收。瓦格纳尔公司只对授权经销商处购买产品的客户提供质保。

本质保不影响买方根据购买合同向卖方就产品缺陷索赔或要求法定权利。

按质保规定，由我公司决定是否更换或修理产品或部件，已更换的产品或部件为本公司所有。

本质保条款替代之前在中国地区发布的质保条款。瓦格纳尔保留在任何时候取消或扩展质保条款的权利。

2. 质保期限

标准质保期限如下：

- 以下机型为**12个月**
所有的HVLP和XVLP系列产品，如Flexio W890, FinishControl 3500, FinishControl 5000, CS 9100
所有半专业无气喷涂设备，ProjectPro 117, Project-Pro 119
- 以下机型为**24个月**
所有专业无气喷涂设备，如柱塞泵、隔膜泵等
所有石膏基涂料喷涂设备，如螺杆泵等
- 对于工业使用或有同等程度的损耗，比如是连班班组操作或租赁等，质保期为**12个月**。

质保期自授权经销商交付之日起开始计算。购买单据原件上的日期具有权威性。

提出质保要求时必须提供原始购买凭证（发票、收据、转账凭证、支付凭证等）。

标准质保仅限设备购买人持有，不可转让。

质保期内更换的部件的质保期仍到从设备初始购买之日起算的质保期为止。超过质保期后在授权维修中心更换的部件的质保期为从更换之日起90天。

一旦质保期已过，则客户不可根据原质保条款提出要求。

3. 流程

如在质保期限内发现涂料、设备运转或性能有缺陷，应立即提出质量保证索赔。

另外，购买方在接收到产品后应立即对设备进行检查。购买方应在接收到货物起的14天内向授权经销商或者本公司书面报告新产品明显缺陷，以免丧失投诉的权利。

交付设备的授权代理商有权受理质保问题。可向指定的维修中心或瓦格纳尔直接提出质保要求。

瓦格纳尔维修中心地址：上海市长建路198号

联系电话：18621971777, 18621963777

关于微信中心的详细信息也可通过瓦格纳尔建筑涂装官方微信平台或致电4006118808咨询。

必须自付运费将产品送修，并附上标有产品采购日期、名称和序列号的原始购买单据。

送维修中心或返还造成的运费以及产品丢失或受损风险均由客户承担。

4. 质保免责

以下情形将不予质保

- 部件由于正常使用或自然磨损造成的磨损老化以及因此导致的产品缺陷。尤其是电缆线、阀门、包装、喷嘴、缸套、柱塞杆、涂料流经组件、过滤器、料管、密封圈、螺杆、螺杆胶套等部件；
- 由于磨损老化导致的损坏，尤其是带小颗粒的涂料所造成的，如分散性漆、灰泥、腻子、黏结剂、釉料、含石英涂料。
- 汽油引擎涂装设备或划线机的离合器组件。
- 由于下述原因导致的设备故障：不遵守操作指南，不适当或不专业的使用，错误组装以及买方或第三方让他人擅自组装，在本设计目的之外的使用，天气反常，涂料不匹配，工作环境不合适，电源电压/频率不对，操作过度，维修，保养以及/或清洁失误。
- 因使用非瓦格纳尔原装配件、附件、或零件而导致的故障。
- 擅自对产品作出改动。
- 序列号已被撤销或模糊不清的产品。
- 非瓦格纳尔授权人员对设备进行了修理。
- 和设定性能略有偏差，但不影响设备的价值和使用的产品。
- 被部分或全部拆开的产品。

5. 其他

上述质保仅限于在中华人民共和国的授权经销商处购买并在该国内使用的产品。

如检查发现了非质保产品，由买方承担修理费用。

上述规定用于调整了我公司与瓦格纳尔保修程序相关的法律关系。

任何额外的索赔，尤其是由于用户对我们产品的不当使用而造成的任何形式的损坏和损失，除非法律和法规另有规定，否则将被排除在产品责任之外。此外，任何非因产品或产品使用直接造成的任何形式的损失的索赔，除非法律和法规另有规定，否则将被排除在产品责任之外。

本规定不影响向经销商提出产品缺陷索赔要求。

本质保符合**中国法律规定**。合同语言是中文。如本质保的中文文本和外文文本意思有偏差时，以中文文本为准。瓦格纳尔建筑涂装保留最终解释权。

瓦格纳尔还能为您提供更多附加价值：只要您在线注册，即可免费享受2+1延保

除了标准质保，我们为中国地区的瓦格纳尔专业建筑涂装设备持有人提供了专项服务：只要注册成为瓦格纳尔金枪俱乐部会员，即可免费多享一年质保以及各种仅面向会员的政策！因为自信，所以承诺！请微信扫描二维码，了解更多信息：



瓦格纳尔建筑涂装
中国上海市
Wagner Spraytech (Shanghai) Co., Ltd.
Division Professional Finishing
1F, No. 58, 3rd Jiangchang Rd
Shanghai 200436
China

Warning!

Mortar spraying machines develop high spraying pressures.

	<p>Attention – Danger of injury!</p>
<p>①</p>	<p>Never reach into the spray jet with your fingers or hand! Never point the spray lance at yourself or other persons! Coating materials are caustic or irritating! Protect your skin and eyes!</p>
<p>②</p>	<p>The following points are to be observed in accordance with the operating manual before every start-up:</p> <ol style="list-style-type: none"> 1. Only connect to the mains supply using a special distributing point, e.g. using a site distribution system with fault current protection with $INF \leq 30 \text{ mA}$. RCD Type B with 30 mA recommended. 2. Observe the permissible pressures. 3. Check all the connecting parts for leaks.
<p>③</p>	<p>Instructions for regular cleaning and maintenance of the machine are to be observed strictly. Observe the following point before any work on the machine and at every working break:</p> <ol style="list-style-type: none"> 1. Observe the curing time of the coating material. 2. Depressurize the spray lance and mortar hose. 3. Switch off the machine.

Ensure safety!

Contents

1	SAFETY REGULATIONS	30
1.1	Working in safety	30
1.2	Operation safety	30
1.3	Electric safety	31
1.4	Motar hose	31
2	INTRODUCTION	32
2.1	Processable materials	32
2.2	Technical data	32
2.3	Description of the mixing pump	33
2.4	Explanatory Diagram (fig. 1)	33
2.5	Operating elements and displays on device (fig. 2)	34
2.6	Motar hose (fig. 3)	35
2.7	Spray lance (fig. 4)	35
3	TRANSPORT	36
3.1	Transport using a crane	36
4	INSTALLATION	37
4.1	Electrical connection	37
4.2	Water connection	37
4.3	Connecting the motar hose	37
4.4	Connecting the spray lance	37
5	START-UP	39
5.1	Dry material	39
5.2	Premixed material	39
6	OPERATION	41
6.1	Replace pump casing	41
6.2	Pauses during work	41
7	MIXER CLEANING AND SHUTDOWN	42
8	MAINTENANCE	43
9	REPAIRS	43
10	ELIMINATING FAULTS	44
10.1	Error messages in the display	44
10.2	Further potential errors	46
11	ACCESSORIES	48
12	SPARE PARTS LIST	50
	Testing of the unit	52
	Note on disposal	52
	Important information on product liability	52
	Guarantee declaration	52
	Service network	56

Explanation of symbols used

	This symbol indicates a potential danger for you or for the device. Under this symbol you can find important information on how to avoid injuries and damage to the device. Special attention must be given to warnings with this symbol.
	Indicates tips for use and other particularly useful information.
	Keep the hands away from the outlet.
	Do not remove protective grid Risk of crushing due to moving parts
	Provides information about noise level

1 SAFETY REGULATIONS

1.1 WORKING IN SAFETY

	To ensure complete safety, read all the instructions in this manual carefully.
--	---

This OPERATION AND MAINTENANCE manual must be kept by the Site Manager and be always available for consultation. The manual is considered part of the machine and must be stored for future reference (EN ISO 12100-2) through to scrapping of the machine itself. If the manual is lost or damaged, a replacement copy can be ordered from the manufacturer.

The manual contains the EC declaration of conformity (2006/42/EC) important information on construction site procedures, installation, operation, maintenance and requests for spare parts. Nevertheless, the user must both have adequate experience and knowledge of the machine prior to use: the user should be trained by a person totally familiar with the operation and use of this machine.

To guarantee complete safety of the operator, safe operation and long life of equipment, follow the instructions in this manual carefully, and observe all safety standards currently in force for the prevention of accidents at work (use of safety footwear and suitable clothing, helmets, gloves, goggles etc.). In order to protect your ears wear ear protection.

	Make sure that all signs are legible.
--	--

	It is not permitted to make changes to the metal structure or systems parts of the mixing pump.
--	--

Wagner accepts no responsibility in the event of damage or defects on machinery or equipment not supplied by Wagner and used in combination with Wagner machinery.

Wagner accepts no responsibility in the event of failure to comply with laws governing the use of this type of equipment, with particular reference to: improper use, incorrect power supply, lack of maintenance, unauthorised modifications, failure to comply, either wholly or partially, with the instructions set out in this manual.

Wagner reserves the right to modify the characteristics of the mixer and/or contents of this manual, without the obligation to update the previous machine and/or manuals.

	The mixing pump is designed for use on building sites. It is for mixing and pumping all factory-made premixed mortar, which, according to the manufacturer are machine compatible: gypsum plaster, anhydrite, lime / cement plaster, heat insulation plaster, mortar for joint grouting etc.
---	---

1.2 OPERATION SAFETY

	Before the mixing pump is put into operation, check whether all protective measures have been correctly fitted.
---	--

	Before the mixing pump is put into operation, check it for visible damage. Particularly electric cables, plugs and connections.
---	--

	When the machine is running do not reach or climb into the funnel or mixing chamber and do not insert any tools.
--	---

	Always use the mixer in sufficiently ventilated environments.
---	--

	Risk of injury from escaping material. Before switching on, always check that the material tap on the spray lance is closed. Close material tap whenever stopping work.
---	--

All of the Wager mixing pump's danger points must be safeguarded with suitable protective measures, which must be kept in perfect working order and must always be correctly mounted. For example, the cooling filter housing for the electro-motors and the funnel protection guard, which prevents contact with the mixer.

In particular, when the motor flange or funnel protection guard is opened, a safety switch causes the moving machine parts to come to a stop.

All current standards governing accident prevention and safety devices must be observed in the workplace.

Take care when handling sacks of material to avoid dispersion of dust with inhalation of the latter; if this is not possible, masks must be worn to protect the mouth and nose.

	Never use the machine in areas subject to the risk of explosion/fires or in underground installations.
---	---

The mixer is not equipped with a lighting system and therefore the workplace must be fitted with adequate lighting.



Before any cleaning or maintenance work is carried out, switch off the mixing pump. Unplug the power plug from the outlet. Do not decouple the mortar hose under pressure. Before decoupling watch the pressure at the manometer.

Never spray off the device with a power spray and especially not with a high-pressure cleaner or high-pressure steam cleaner. Danger of short-circuits caused by water ingressing!

1.3 ELECTRIC SAFETY

The PlastMax mixing pump meets the requirements stated in directive EN 60204-1 and is protected against sprays of water, overloading and power failures.

The mixing pump must be grounded.

Only connect to the mains supply using a special distributing point, e.g. using a site distribution system with fault current protection with $INF \leq 30$ mA. RCD Type B with 30 mA recommended.

The power lines must be laid to prevent any possible damage. Never place the mixer on electric power cables.

Ensure that the electrical connection is protected against the risk of water penetration in connectors. Use exclusively connectors and couplings equipped with water spray protection.

- Never use inadequate or provisional electric lines: if in doubt consult specialist personnel for assistance.

- Repairs to the electrical circuit must be performed exclusively by specialised personnel. Disconnect the machine from the power supply before performing maintenance or repairs.

-The electric cables may not touch any moving parts and/or machine parts in motion, as in the event of damage, the metal parts could be energised.

1.4 MORTAR HOSE

Only use identified mortar hoses with an operating pressure of at least 40 bar.

	<p>Danger of injury through leaking mortar hose. Wear and tear and links as well as usage that is not appropriate to the purpose of the device can cause leakages to form in the mortar hose. Liquid can be injected into the skin through a leakage.</p>
--	--

Mortar hoses must be checked thoroughly before they are used.

Replace any damaged mortar hose immediately.

Never repair defective mortar hoses yourself!

Avoid sharp bends and folds: the smallest bending radius is about 80 cm.

Do not drive over the mortar hose. Protect against sharp objects and edges.

Never pull on the mortar hose to move the device.

Do not twist the mortar hose.

Lay the mortar hose in such a way as to ensure that it cannot be tripped over.

	<p>Only use WAGNER original-mortar hoses in order to ensure functionality, safety and durability.</p>
	<p>The risk of damage rises with the age of the mortar hose. Wagner recommends replacing mortar hoses after 6 years.</p>

2 INTRODUCTION

2.1 PROCESSABLE MATERIALS

The mixing pump is suitable for the universal mixing of the following materials:

- Mineral thermal insulation composite system adhesives and reinforcement
- Building adhesive
- Mineral textured plaster up to about K 5 mm
- Lime-cement plasters
- Cement plasters
- Interior lime plasters
- Gypsum plaster



Processing of other coating materials only after consultation with WAGNER application technology.

2.2 TECHNICAL DATA

Voltage:	220-230 V ~, 50-60 Hz
Unit connecting line :	6 m long, 3 x 2.5 mm ²
Unit connecting line :	6 m long, 3 x 2.5 mm ²
Max. performance:	3.4 kW
Gearmotor:	2.2 kW
Water pump:	0.45 kW
Compressor:	0.75 kW
Water connection:	3/4"
Waterpressure setting (min):	2.5 bar
Mixing capacity (approximate):	15 l/min
Max. operating pressure:	40 bar
Dimensions L x W x H:	1450 x 685 x 1270 mm
Loading height:	1000 mm
Maximum grain size:	5 mm
Hopper capacity:	60 l
Max. mortar hose length:	
Hose diameter 25mm	20 m
Hose diameter 35mm	30 m
Weight:	191 kg
Degree of protection:	IP 54
Noise emission level*:	
L _{PA} at 1 m	< 76 dB (A)
L _{WA}	90 dB (A)

* The table shows the sound pressure levels of the mixer measured at the ear of the operator (L_{PA} at 1 m) and noise emission levels in the environment (power L_{WA}) measured according to EN ISO 3744 (2000/14/CE)

2.3 DESCRIPTION OF THE MIXING PUMP

The mixing pump is composed of a frame with wheels, to which a container with safety guard, an electro-motor with mixer, a water system with pressure booster pump and a compressor are fitted.

The pre-mixed or dry material is filled into the container. Inside the container are mixers driven by a gear motor. When the dry material is processed, it is mixed with water supplied by the water system. The water system takes the water from the water network or from a container designed for the purpose. The water through-put is regulated by a volume regulator and a flow meter.

The mixer has a helical rotor pump, which pumps the material by mortar hose to the spray lance. In addition to the mortar hose, the spray lance is also connected to an air hose. The material is atomised at the spray lance with the air supplied by the compressor.

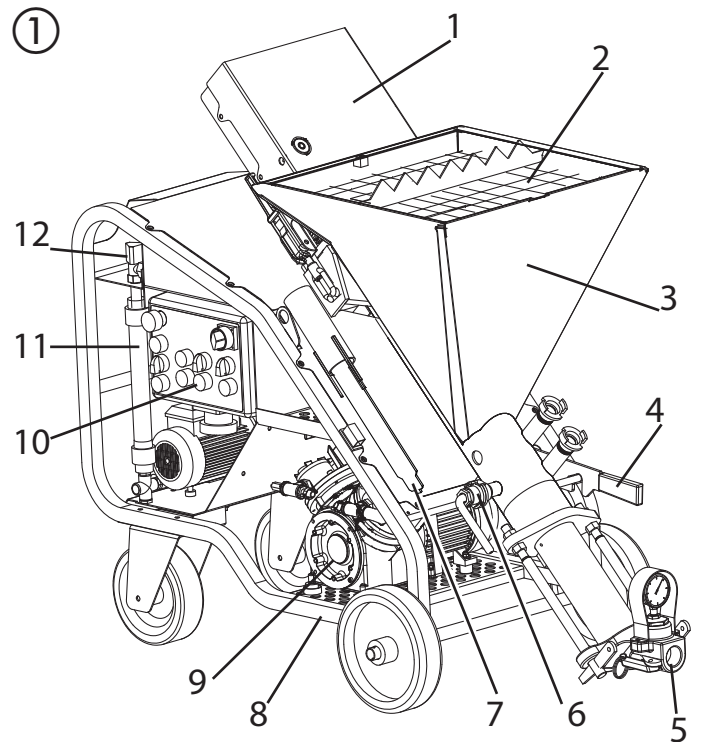

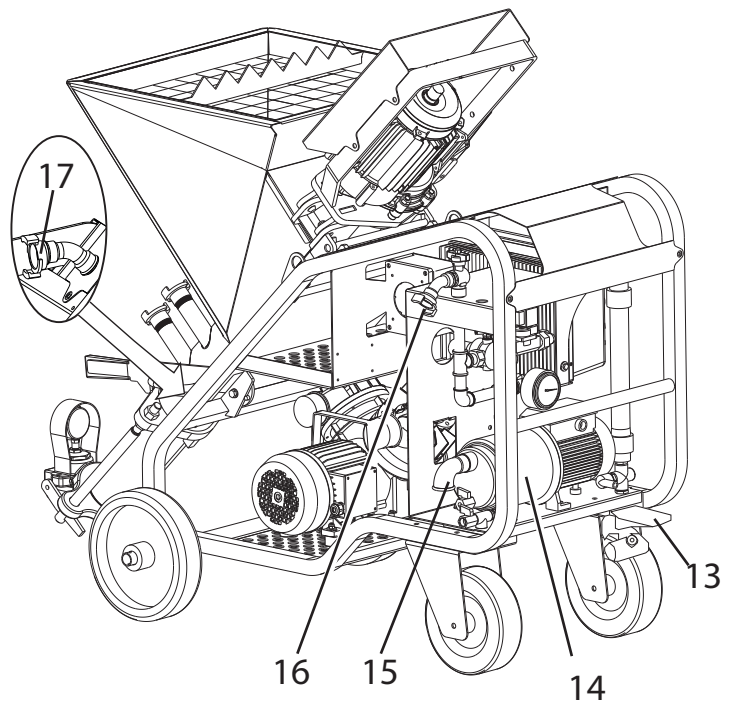

2.4 EXPLANATORY DIAGRAM (FIG. 1)

- 1 Electric motor with transmission
- 2 Safety guard
- 3 Hopper
- 4 Lever to set the tilt angle
- 5 Material outlet
- 6 Cleaning tool for water connection
- 7 Cleaning tool for mixing chamber
- 8 Wheeled frame
- 9 Compressor
- 10 Electrical panel
- 11 Water flow meter
- 12 Water volume regulator
- 13 Brake
- 14 Pressure booster pump
- 15 Water connection
- 16 Cleaning connection for mortar hose
- 17 Air connection

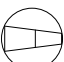

2.5 OPERATING ELEMENTS AND DISPLAYS ON DEVICE (FIG. 2)

- 1 Main switch: Switches machine on (I) and off (0)
- 2 Selector switch for operating mode:
Pneumatic = Operation with pneumatic spray lance
Automatic = Operation with automatic spray lance
- 3 Indicating lamp (blue): indicates presence of line voltage
- 4 Speed regulator (+ and -): The selected speed (1 to 4) is shown in the display
- 5 Display
- 6 Selection switch for conveyor pump:

-  Conveyor pump is at standstill
-  Forwards motion gear: The material is conveyed to the spray lance
-  Reverse gear: The conveyor pump runs in reverse. For example to relieve pressure

- 7 Error display (red): Lights up when a problem is incurred. An error code is also shown in the display
- 8 On/Off switch for water pump: Switches on water pump as required (position I)
- 9 Pilot lamp for water pump (green): Lights up when the pump is switched on to supply water
- 10 Water supply: Press to switch the water supply on and off
- 11 When the EMERGENCY STOP switch is pressed, the PlastMax is switched off immediately. Turn the EMERGENCY STOP switch in order to release it again. The machine remains switched off after release. To switch it back on again, the main switch has to be pressed again.
- 12 Water volume regulator: The required volume of water is set by turning the regulator
- 13 Water flow meter: Shows the set volume of water

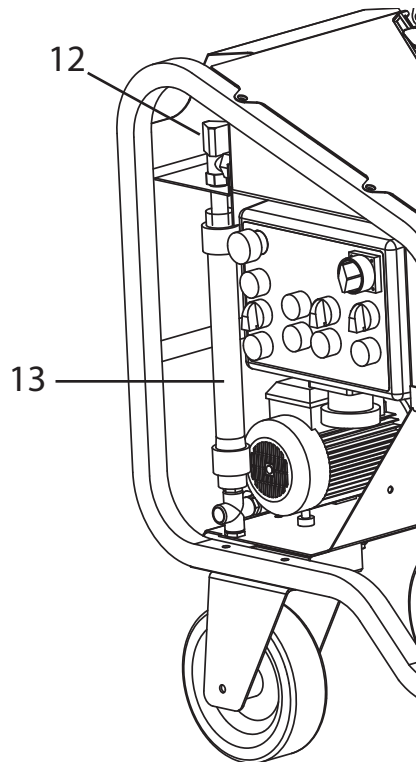
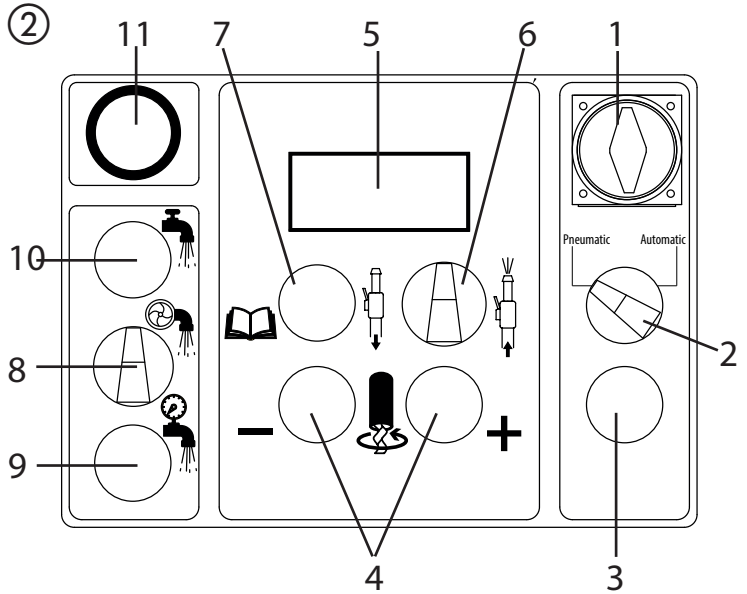

2.6 MORTAR HOSE (FIG. 3)

- 1 Material connection mortar spraying machine
- 2 Control cable connection / controller (automatic version only)
- 3 Atomizing air connection compressed air supply
- 4 Material connection spray lance
- 5 Mortar hose
- 6 Atomizing air connection spray lance
- 7 Control cable connection/ automatic spray lance (automatic version only)

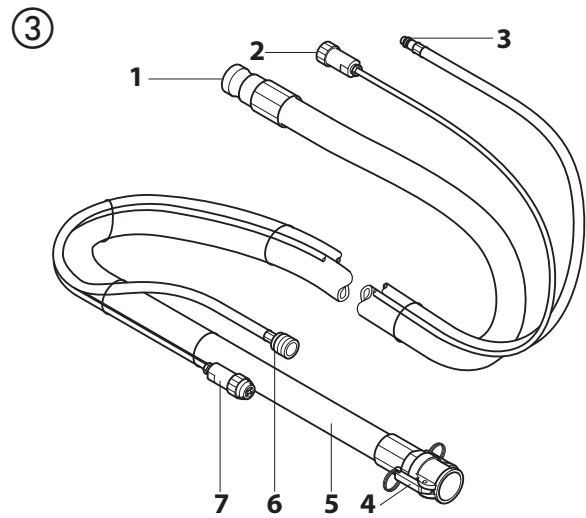

2.7 SPRAY LANCE (FIG. 4)

- 1 Material connection
- 2 Combined material and air tap:
Open: material tap at 90° to spray lance
Closed: material tap points forwards
- 3 Rendering tip:
Various rendering tips can be used in the rendering lance. The tip size depends on the granular size of the coating material and the desired spray pattern.
- 4 Hand-grip:
The hand-grip can be mounted to either the right or left side of the spray lance, depending on what is required. The thread on the other side can be closed by way of the attached stoppers for protection.
- 5 Control cable connection (automatic version only)
- 6 Air flow regulator
- 7 Atomization air connection

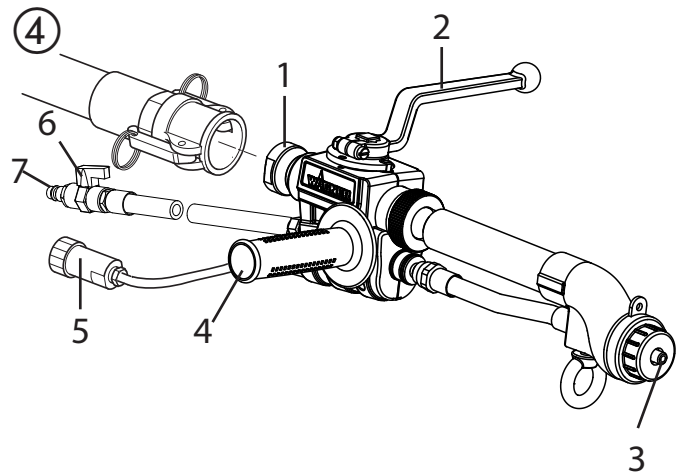



For work with the automatic spray lance, you need a stronger compressor (e.g. C330/03, accessory).

3 TRANSPORT

	CAUTION! Before moving the mixing pump, always detach the power plug.
--	--

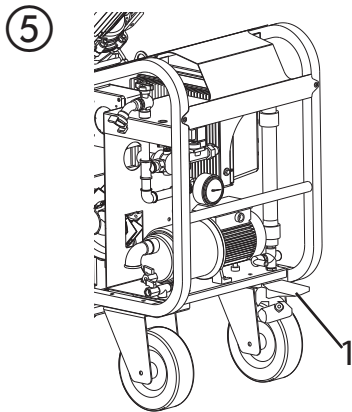
Before moving the mixer, disconnect the water supply hose. Only a minimal amount of the material should be in the hopper when handling. Release brake (fig. 5, 1). Push the mixing pump in the desired direction.



	To ease transport, the machine can be taken apart into motor, container and compressor.
--	---

3.1 TRANSPORT USING A CRANE

	CAUTION! Before lifting the mixing pump, always check that all machine components are correctly secured and fitted in place and no objects have been left on the surface.
---	--

	WARNING! Always disassemble the compressor before lifting the mixing pump and transport it separately.
---	---

	CAUTION! Lift with care to avoid hazardous oscillations.
---	---

	WARNING! The machine may only be lifted at the lifting zones shown in fig. 6. Do not attach any lifting tackle to the cover of the gear motor.
---	---

Use lifting tackle that is suitable for the overall weight of the machine (191 kg). To lift the machine, use the two rings (one on each side of the machine) as shown in the picture below.

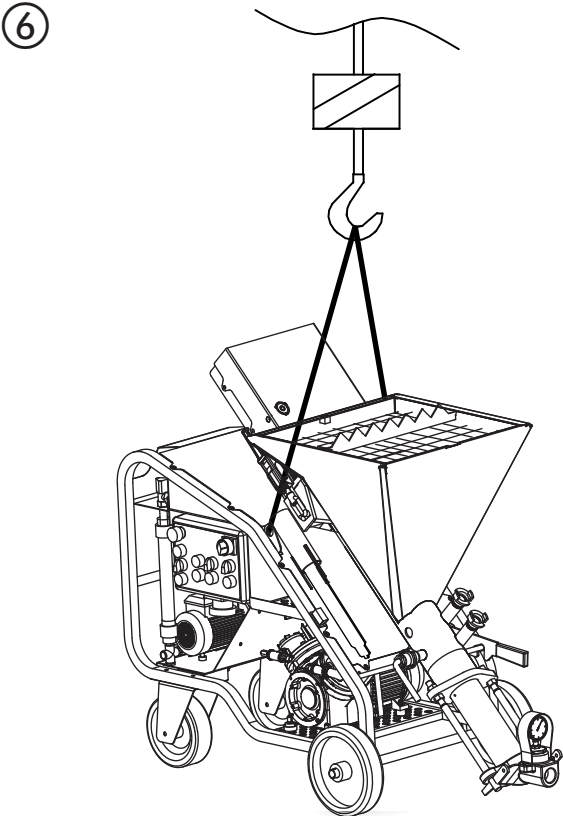

4 INSTALLATION

Install the mixing point on level ground at the work site and in such a way that it is not an obstacle during the work and also not during the subsequent cleaning process. The hoses must be kept as short as possible.

- Block the wheel with the brake.
- Set up the mixer so that no liquids (e.g. rain) can get into the hopper.

4.1 ELECTRICAL CONNECTION

	Check that the supply voltage, mains frequency and power connection (socket, fuses, cable) correspond to the information on the rating plate.
--	--

The electrical power socket must be fitted with protection against current overload (e.g. by means of fuses or a thermal magnetic cut-out) and against dispersion current to earth (e.g. with a differential circuit breaker). The electric cable wire size must take into account the operating currents and length of the line to avoid excessive voltage drops.

	WARNING! Use only extension cables with a cross-section of 3x2.5 mm². Do not use cable drums.
--	---

The power cable must be suitable for frequent movements and with an abrasion resistant sheath (e.g. type H07RN-F). Before connecting the mixer to the electrical mains, ensure that all safety devices are fitted and are in perfect condition. Check that the extension cable is in a good condition and that the sockets and plugs are dry.

Connect the mixer socket on the electrical panel to the mains (fig. 7, 1).

Connect the plug with the mains. The blue pilot lamp (fig. 7, 2) lights up in the control panel.

If the pilot lamp does not light up, there is either no electricity or the voltage is greater than 240 V.

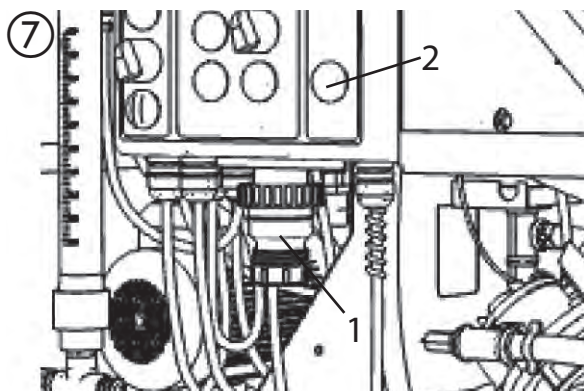

4.2 WATER CONNECTION

Connect the water connection (fig. 8, 1) with the water network.

	The water system must be able to ensure a delivery rate of at least 15 l/min and a minimum pressure of 2.5 bar.
--	---

If the water supply is not sufficient, a water tank of about 200 litres (must be kept full during operation) of clean water can be used.

Connect a max. 3-m long hose (minimum diameter 3/4", preferably with floor filter), which cannot become misshapen during operation, to the pressure booster pump (fig. 8, 1).

	Important. When connecting it to the water tank for the first time, and whenever the water system is emptied or after the machine has been at standstill for a long time, the suction hose has to be filled by hand in order to put the pump into operation.
--	--

Connect the hose to the water tank.

Set the on/off pump switch (fig. 8, 2) to I and the green pilot lamp (3) lights up.

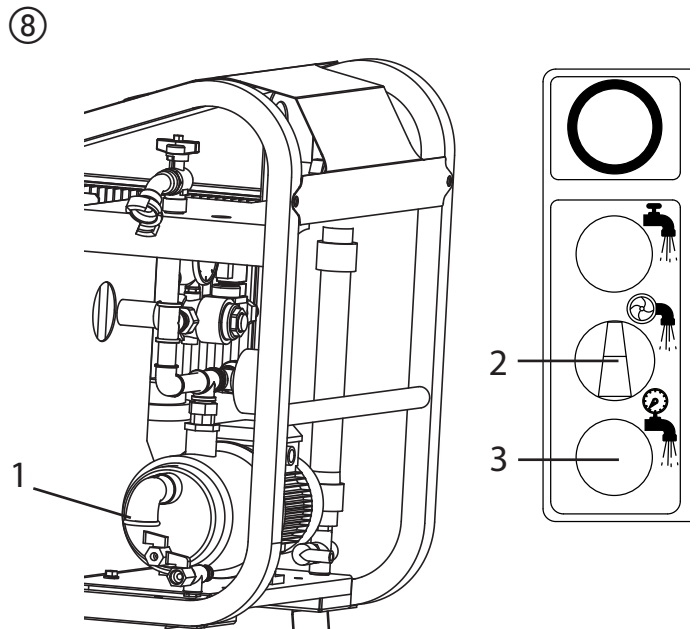

4.3 CONNECTING THE MORTAR HOSE

Connect the mortar hose (fig. 9, 3) to the material outlet and secure it with a clamping lever (4).

When using an air hose with a quick connector: Mount the included adapter (7) to the air connection (8).

Connect the atomiser connection (6) on the mortar hose to the adapter (7) or air connection (8).

When using the automatic version: Screw the remote control to the connector (5).

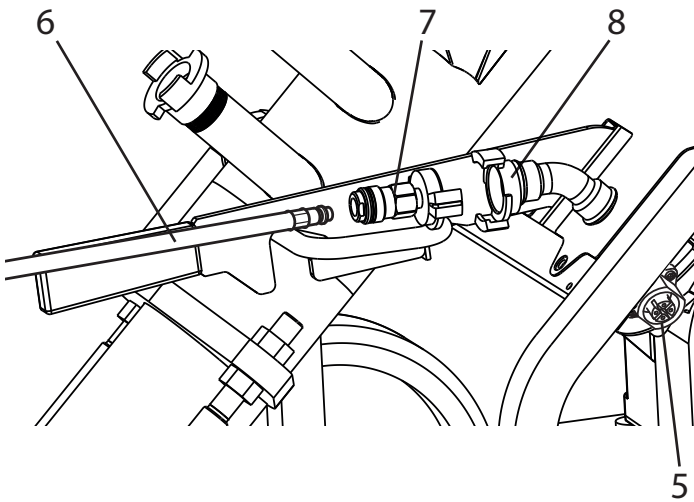
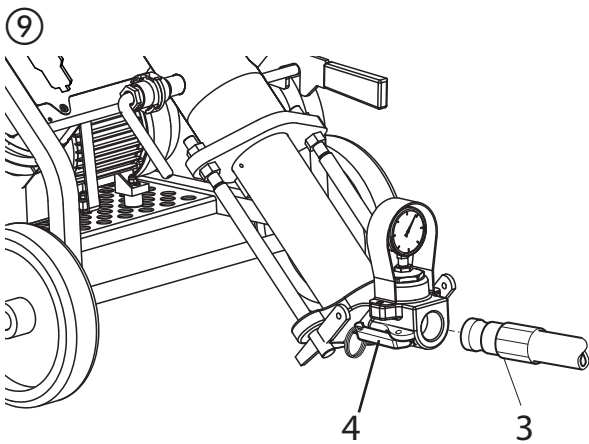

4.4 CONNECTING THE SPRAY LANCE (FIG. 10)

i A number of different sized nozzles are included in the accessories. A small nozzle diameter produces fine atomisation. Nozzles with a larger diameter are best for large-grained materials. The tip size should amount to at least three times the granular size, e.g. granular size artificial resin plasters -> 3 mm Tip size -> 10 mm

Select a spray tip suitable for the material.

i Make sure that the air hole remains free. If necessary clean with the cleaning pin (0342 916).

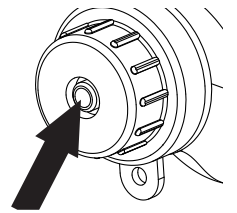



Connect the rendering tip (fig. 10, 3) to the rendering lance. Connect the rendering lance (1) to the material hose and secure by applying the levers (8).

Connect atomization air connection (7) to the air hose of the mortar hose.

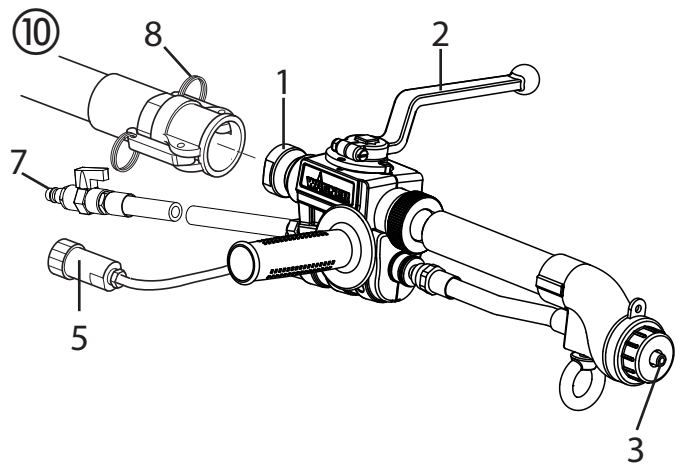
Automatic version only: Screw coupling plug (5) for remote control to the control cable of the mortar hose.



5 START-UP

	<p>The protective guard must always be mounted properly and correctly. Removing the protective guard causes any moving machine parts to stop. To put the machine back into operation, the protective guard has to be reinserted and the main switch set to 0.</p>
	<p>Only suitable dry material or premixed material may be put into the container.</p>

5.1 DRY MATERIAL

	<p>To avoid blockages, the mortar hose should be rinsed. Attention! Water is not sufficient as a sliding means. Danger of clogging! Use cellulose paste (e.g. Metylan wallpaper paste, art no. 2312136)</p>
---	---

Set the selector switch for the operating mode (fig. 11, 19) to pneumatic (for pneumatic lance) or automatic (for automatic lance).

Fill cellulose glue into the mortar hose, connect to the material outlet and secure with a clamping lever (4).

Disconnect the water hose (17) and the blind plugs (18) from the connections.

Remove any remaining materials by moving the cleaning tool back and forth (12). Afterwards, take the cleaning tool out of the opening.

	<p>Depending on the material, the water hose (17) should be fitted to a different connection: materials that mix easily = lower connection materials that do not mix easily = upper connection</p>
---	--

If necessary, remove the blind plugs (18) and connect the water hose (17).

Press the water supply button (9) and keep it held until water exits from the opening of the cleaning tool.

Re-insert the cleaning tool and close correctly.

Fill the container with the material from the sacks. (Fig. 13).

Set the water flow displayed on the flow meter (fig. 11, 14) with the water volume regulator (13).

- for materials based on cement -> 300 l/h

- for materials based on gypsum -> 500 l/h

Turn the main switch (fig. 11, 1) on the switch panel to 1 in order to switch on the compressor.

Activate the two buttons (fig. 11, 3) until the operating modes 2 or 3 are shown on the display (4).

Turn the start switch (fig. 11, 5) to operating position (to the right).

Hold spray lance over an empty bucket.

Close the air flow regulator (fig. 12, 15).

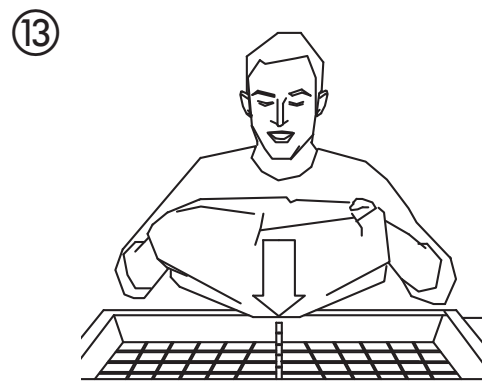
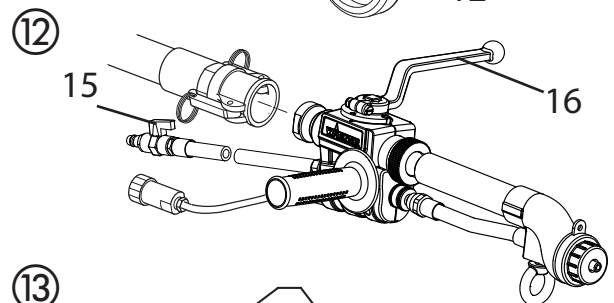
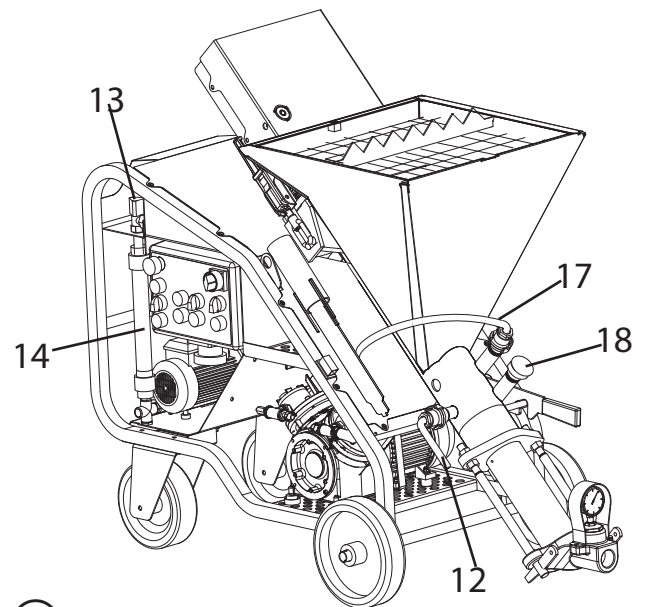
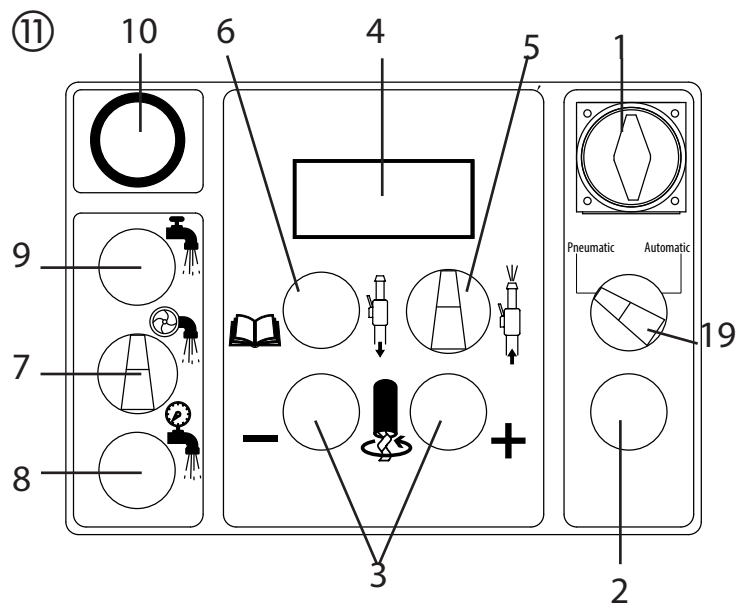

Open material tap (Fig. 12, 16) on spray lance (material tap at 90° to spray lance).

If cellulose paste comes out of the tip, close the material tap (fig. 12, 16) (material tap points forwards).

The machine is now ready for operation.

5.2 PREMIXED MATERIAL

	<p>To avoid blockages, the mortar hose should be rinsed. Attention! Water is not sufficient as a sliding means. Danger of clogging! Use cellulose paste (e.g. Metylan wallpaper paste, art no. 2312136).</p>
--	---

Set the selector switch for the operating mode (fig. 11, 19) to pneumatic (for pneumatic lance) or automatic (for automatic lance).

Fill cellulose glue into the mortar hose, connect to the material outlet and secure with a clamping lever (4).

Fill the container with the premixed material.

Turn the main switch (fig. 11, 1) on the switch panel to 1 in order to switch on the compressor.

Activate the two buttons (fig. 11, 3) until the operating modes 2 or 3 are shown on the display (4).

Turn the start switch (fig. 11, 5) to operating position (to the right).

Hold spray lance over an empty bucket.

Close the air flow regulator (fig. 12, 15).

Open material tap (Fig. 12, 16) on spray lance (material tap at 90° to spray lance).

If cellulose paste comes out of the tip, close the material tap (fig. 12, 16) (material tap points forwards).

The machine is now ready for operation.

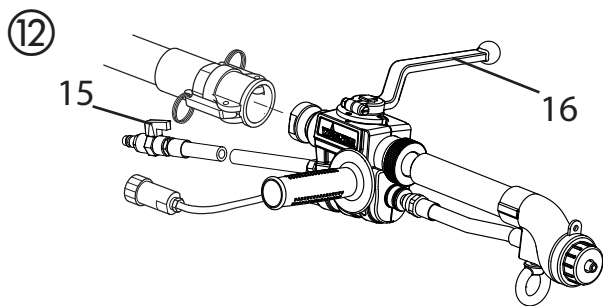
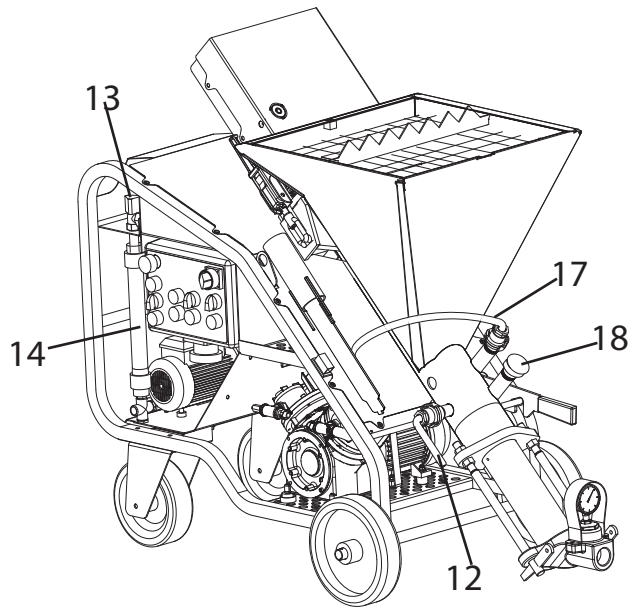
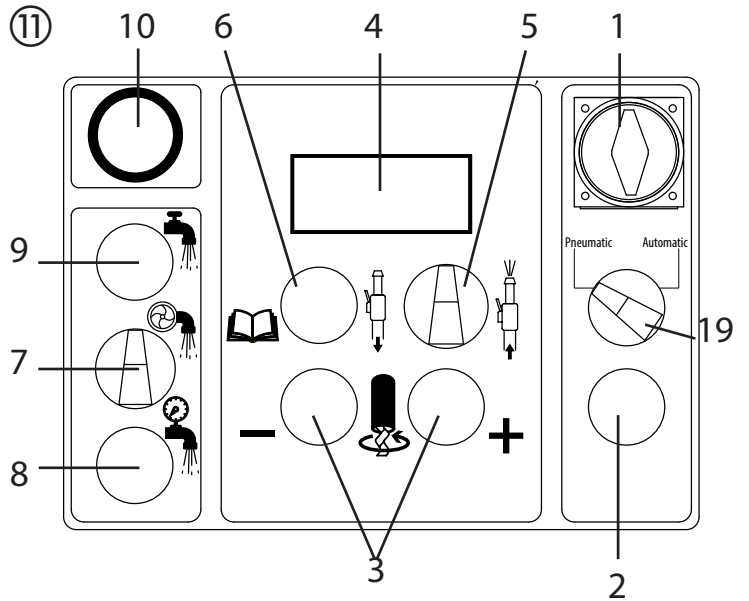

6 OPERATION

	<p>The protective guard must always be mounted properly and correctly. Removing the protective guard causes any moving machine parts to stop.</p> <p>To put the machine back into operation, the protective guard has to be reinserted and the main switch set to 0.</p>
--	--

	<p>Wear envisaged personal protection devices before starting work.</p>
--	---

	<p>In an emergency, interrupt the operating of the machine by pressing the red ON/OFF switch. This causes all moving parts to stop. Next, disconnect the plug.</p>
--	--

	<p>The electric motor is protected against overload by a thermal cutout. The mixer has to be switched back on again via the ON/OFF switch once it has cooled down.</p>
--	--

Open the air flow regulator (fig. 12, 15) and the material tap (fig. 12, 16) at the spray lance.

Adjust the flow of material with the delivery volume controller (fig. 11, 3) on the control unit and set the air quantity by adjusting the air flow regulator (fig. 12, 15) to attain the desired spray pattern.

	<p>Important: Never interrupt the water supply during the processing of dry materials. If no water is flowing, the machine will stop. Before putting the machine back into operation, find out what the cause of the problem is: Tap off, supply hose bent, tank empty, filter blocked.</p>
--	---

	<p>The mixture coming out of the spray lance can be optimised by correcting the water volume. Change the water flow in 20-l steps with the water volume regulator (fig. 11, 13) until you have the right consistency.</p>
--	---

	<p>Increased material tap wear. Do not use the material tap to set the material volume. The delivery volume controller should be used for this purpose.</p>
--	---

	<p>In the event of a power failure during the work, the machine and the hoses have to be rinsed as soon as possible. Similarly, dismount the pump, take the rotor out of the stator and wash it. Next, assemble all the parts.</p>
--	--

6.1 REPLACE PUMP CASING

	<p>Attention! Before disassembly, make sure that no residual pressure remains. Watch the manometer --> 0 bar. Switch off machine and disconnect from power supply.</p>
--	--

Remove splint at outlet unit.
Disconnect outlet unit and pump casing.
Mount the desired pump casing (accessory).

6.2 PAUSES DURING WORK

Take note the material hardening time.
If at standstill for too long, the material hoses can become blocked:
In this case, no material can emerge from the spray lance and the manometer indicates a higher pressure than the normal operating pressure.
Turn the main switch to 0 to stop the machine.
Look for the blocked part of the hose and hit it with a hammer to remove the material from the hose.

	<p>Attention! If the spray lance is removed or the lead connections have to be opened, make sure that there is no pressure inside. Put the machine into reverse (max. 5 seconds) briefly to relieve the pressure. The material manometer must read 0 bar and the hoses should be soft, with the exception of the possible blockage. The operator carrying out the procedure must receive an appropriate briefing. If you are in any doubt whatsoever that there is a remaining pressure in the hoses, the connections may not be opened.</p>
--	---

7 MIXER CLEANING AND SHUTDOWN

After the work, carry on pumping until the container and the material hoses are empty.



Attention! Before removing the spray lance or the hoses, always make sure that there is no residual pressure. Watch the manometer --> 0 bar.

Run the machine in reverse to relieve the pressure.
Turn the main switch to 0 to switch off the machine.

Remove the in-wall lance and clean as follows:

- Clean the texture tip (fig. 14, 1).
- Clean the air holes with a cleaning needle
- Clean and lubricate the O-ring (fig. 14, 2).
- Clean the spray lance and material tube on the inside using a bottle brush (0342329).
- Clean all threads thoroughly.
- Rinse the spray lance with clear water. Open and close the material tap three times as you are doing this.

Decouple the mortar hose from the outlet unit.

Insert cleaning ball into mortar hose

Connect the mortar hose to the cleaning connection (fig. 15, 3).
Switch on the water pump and open the water tap until the cleaning ball emerges at the other end.

Repeat the procedure until the hose is cleaned properly.

Release the quick-release connection with the guard and open the mixing chamber in the container. (Fig. 16)

Take out the mixer (fig. 16, 1) and wash it.

Clean the mixing area with a spatula.

Insert the cleaning tool and hook up to the gear motor at the connection. (Fig. 17)

Switch on the machine until the cleaning procedure has completed.

Stop the machine and remove the cleaning tool.

Install the clean mixer again.

After the machine has been cleaned, switch off the main switch, disconnect the power supply from the plug, close the water supply, turn on the additional tap for a few seconds and then disconnect the supply hose.

If there is any indication of frost whatsoever, turn on the four taps (fig. 18) of the water system and drain all the water out of the water system.

The taps have to be turned off again before the machine is put into operation.

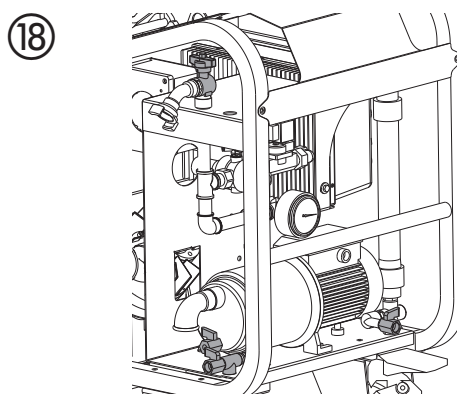
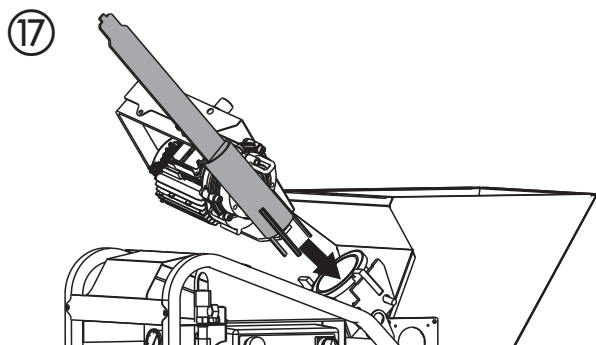
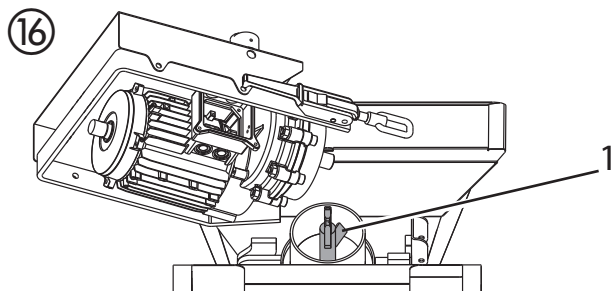
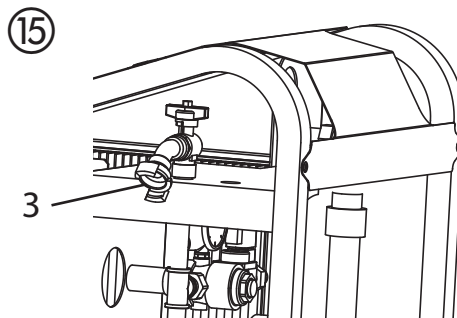
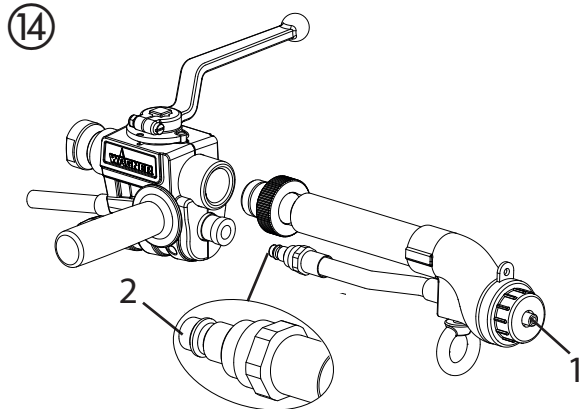

8 MAINTENANCE

	Maintenance must be performed by adequately trained personnel, after switching off the machine, disconnecting it from the power supply and emptying the hopper.
--	--

Check daily that the water filter (fig. 19, 1) is clean.
 Check once a week that the compressor-air filter (fig. 19, 2) is clean. If it shows signs of wear and tear or is damaged, it must be replaced.
 Check that the mixer is functioning properly once a week, and replace if necessary.
 Check weekly that the electric motors are free of dust and dirt and if necessary clean using compressed air.
 Check weekly that the plug and socket contacts are clean, dry and rust free.
 Every 12 months arrange for an inspection of the machine by an authorised Wagner service centre.

	Spent oil is a special waste. Therefore it must be disposed of according to current legislation.
--	---

	Always keep notices and symbols on the machine legible.
--	--

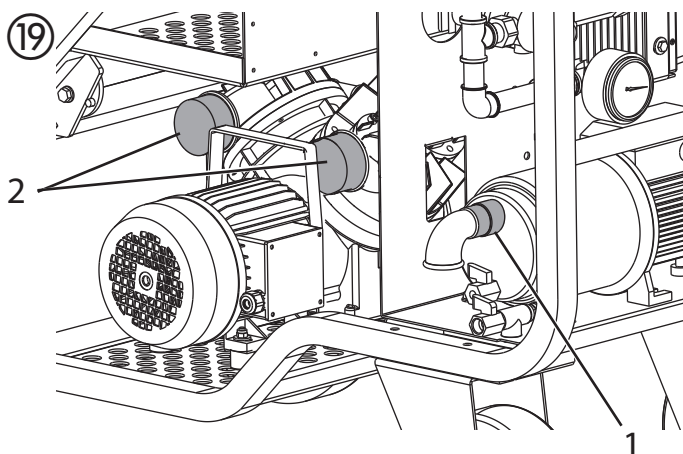

9 REPAIRS

	Do not operate the mixing pump during repair work. Repairs to electrical fittings may only be carried out by specialist personnel. When required, use only original Wagner spare parts that have not been modified in any way.
--	---

	If protective covers have to be removed during the repair work, make sure they are mounted correctly afterwards.
--	---

The emergence of alternately hard and soft material can be the sign of wear and tear to the pump.
 To replace the stator/rotor, proceed as follows:

	Attention! Before disassembly, make sure that no residual pressure remains. Watch the manometer --> 0 bar. Switch off machine and disconnect from power supply.
--	---

Release the handle to the left of the container.
 Position the pipe wrench at the end of the mixer and turn it so that the rotor can be taken out of the inside of the stator.
 Close the handle, put the funnel unit at an angle and block it in a raised position. Dismantle the collective material pipe and mount the new rotor/stator pair.
 Before assembling the rotor in the stator, spray the thread-parts with a lubricant spray, available from Wagner. Never use mineral oil or grease, as this can damage the stator. Avoid the use of any benzenes.

10 ELIMINATING FAULTS

10.1 ERROR MESSAGES IN THE DISPLAY



In the event of malfunctions during operation, the following error messages can appear in the display.

ERROR MESSAGES IN THE DISPLAY	POSSIBLE CAUSE	ELIMINATION
ERR00	<ul style="list-style-type: none"> - Protective guard is missing or not in correct position - Temperature monitor in engine of spiral pump (see Err02) - Emergency off switch is activated - System fault 	<ul style="list-style-type: none"> - Check to see if the guard is positioned correctly - Allow time to cool down before restarting - Allow time to cool down before restarting - Please contact Wagner Service
ERR01	<ul style="list-style-type: none"> - High temperature of electronic board (inverter) 	<ul style="list-style-type: none"> - Allow time to cool down before restarting
ERR02	<ul style="list-style-type: none"> - Higher temperature of spiral pump motor - The motor has been overloaded for too long. 	<ul style="list-style-type: none"> - Allow time to cool down before restarting - Correct the mixture that is being used
ERR03	<ul style="list-style-type: none"> - The spiral pump motor is overloaded (motor is blocked) 	<ul style="list-style-type: none"> - Add water to the mixture - Add binding agent to the mixture - Use sand with a suitable grain size distribution - Remove blockage.
ERR04	<ul style="list-style-type: none"> - The spiral pump motor is revolving, however it is overloaded 	<ul style="list-style-type: none"> - Use sand with a suitable grain size distribution - Add water to the mixture - Add binding agent to the mixture - Reduce the motor speed of the spiral pump - When the machine is running, make sure that the supply voltage is between 200 and 230 volt, that the supply cable is dimensioned correctly and that no other devices (cranes, lifting units, sawing machines, concrete mixers, etc.) are connected to the same supply line.
ERR05	<ul style="list-style-type: none"> - The compressor switches on and off too frequently even through the air tap to the spray lance is turned off - Hole in air hose - Leak at connections 	<ul style="list-style-type: none"> - Replace spray lance - Replace air hose - Check connections
ERR06	<ul style="list-style-type: none"> - Current supply voltage is higher than 265 volt 	<ul style="list-style-type: none"> - Have the current quality at the output of the supply source checked by a specialist.
ERR07	<ul style="list-style-type: none"> - Loss of voltage against ground or system fault 	<ul style="list-style-type: none"> - Please contact Wagner Service - Check to see if water is penetrating the system
ERR08	<ul style="list-style-type: none"> - Supply voltage is too low (below 170 volts) 	<ul style="list-style-type: none"> - When the machine is running, make sure that the supply voltage is between 200 and 230 volt, that the supply cable is dimensioned correctly and that no other devices (cranes, lifting units, sawing machines, concrete mixers, etc.) are connected to the same supply line.

ERROR MESSAGES IN THE DISPLAY	POSSIBLE CAUSE	ELIMINATION
BLOC	<ul style="list-style-type: none"> - The spiral pump motor is blocked 	<ul style="list-style-type: none"> - Check to see if stator and rotor are wedged together (dismantle and free/replace) - Remove foreign body from funnel/from mixing chamber
STOP	<ul style="list-style-type: none"> - Warning message air to closed lance - Gun nozzle / air pipe blocked, the machine cannot start after break 	<ul style="list-style-type: none"> - Open lance - Clean air nozzle, unblock the air pipe
H2O	<ul style="list-style-type: none"> - Water pressure below 2.5 bar; insufficient throughput/pressure for correct functioning - The machine has switched itself off and on again; the display is flashing H2O for several seconds. - Air in pipe/system - Automatic lance is closed 	<ul style="list-style-type: none"> - Switch on the machine's water pump - Check to see if the filter in the hydraulics system of the machine is clean - Let water run out of the drain tap in order to vent the pipe/system - There is no error

10.2 FURTHER POTENTIAL ERRORS

MALFUNCTION	POSSIBLE CAUSE	ELIMINATION
Machine is not starting	<p>Water</p> <ul style="list-style-type: none"> - Water pressure is too low: The manometer is indicating a pressure below 2 bar (is the green pilot lamp on?), the display is showing H2O <p>Material</p> <ul style="list-style-type: none"> - Product in mixing chamber is too dry (mortar pump blocked? Is red pilot lamp on?) <p>Air</p> <ul style="list-style-type: none"> - Air pressure does not go under the minimum pressure of the machine pressure switch when gun tap is fully open <p>Guard</p> <ul style="list-style-type: none"> - The guard is not mounted correctly, the display shows Bloc <p>Controller</p> <ul style="list-style-type: none"> - Control cable is not connected (for automatic mode) - The controller for pneumatic mode is set to "Automatic" - The controller for automatic mode is set to "Pneumatic" 	<ul style="list-style-type: none"> - Check whether water is leaking out of the supply line - Check to see if the water filter is clean - Check to see if the water pump is switched on - If the pump is drawing water from a tank, check to see if it fills correctly the first time, and make sure that the connections are not leaking - First machine start not correct (see chapter 5) - Water throughout is set too low (see chapter 4.2) - No water supply to mixing chamber (water input blocked, water magnet valve is not functioning) - Check to see if air hose is bent or blocked - Check to see if spray nozzle really is clean - Mount guard correctly - Connect control cable (see chapter 4.2) - Switch to "Pneumatic" - Switch to "Automatic"
Neither machine nor compressor can start and the blue pilot lamp is off	<ul style="list-style-type: none"> - No current at plug on building-site circuit board (fuses?) - No power supply to machine (connection plug defect? Cable broken?) - The main switch is not switched on 	<ul style="list-style-type: none"> - Check points listed alongside
The machine cannot start, but the compressor starts	<ul style="list-style-type: none"> - Operating switch has not been activated - Signal for pressure switch for min. water pressure at start (is the water pump switched on? See also "Machine does not start", cause water) 	<ul style="list-style-type: none"> - Check points listed alongside

MALFUNCTION	POSSIBLE CAUSE	ELIMINATION
Machine and/or compressor does not stop	<ul style="list-style-type: none"> - Air hose defect (hose cut through? Is air emerging from the connections?) - Compressor is not producing enough pressure air - Air tap to lance is defect (blocked in open position) - Pressure switch is defect 	<ul style="list-style-type: none"> - Check air hose, particularly the connection screw points, and replace if necessary - Check air filter (see chapter 8) - Replace spray lance - Please contact Wagner Service
Machine stops after being put into operation	<ul style="list-style-type: none"> - Suction filter is blocked - The filter on the pressure reducer is blocked - Water hose too long and/or too thin - Water supply is not sufficient 	<ul style="list-style-type: none"> - Check the following listed items: Clean filter, check whether water throughput at water hose is sufficient (min. 10-12 l/min for lime/cement mortar, min 15-20 l/min for gypsum plaster). Replace the hose if necessary or draw water from an additional tank
The flow of the material is interrupted (air bubbles)	<ul style="list-style-type: none"> - Mixer is not suitable for this product - Mixing chamber is blocked with material 	<ul style="list-style-type: none"> - Clean mixer and if necessary replace with one that is suitable for the product - Clean and dry the mixing chamber and continue with work
The flow of the material is interrupted	<ul style="list-style-type: none"> - Material hose is blocked - Blockage in spray lance 	<ul style="list-style-type: none"> - Remove blockage
Material in lance is not consistent - too hard or too liquid	<ul style="list-style-type: none"> - Badly pre-mixed material - The rotor-stator component is worn - Mixer not suitable or worn 	<ul style="list-style-type: none"> - Check points listed alongside
The water in the mixing chamber increases during operation	<ul style="list-style-type: none"> - The rotor-stator component is worn 	<ul style="list-style-type: none"> - Replace rotor stator
Water in the mixing chamber increases when machine is at standstill	<ul style="list-style-type: none"> - Magnet valve defect 	<ul style="list-style-type: none"> - Check

11 ACCESSORIES

ITEM	PART NO.	DESIGNATION
1	2370 170	Automatic spray lance*
2	2334 121	Rendering lance (automatic version)
3	2334 122	Rendering lance (pneumatic Version)
4	Texture tips for automatic spray lance:	
	0268 779	Texture tip 4
	0348 915	Texture tip 5
	0268 780	Texture tip 6
	0348 916	Texture tip 7
	0268 781	Texture tip 8
	0348 917	Texture tip 9
	0268 782	Texture tip 10
	0342 327	Texture tip 12
	0342 328	Texture tip 15
	0268 905	Texture tip set 4, 6, 8, 10
5	2362 235	Rendering tip 10
	2362 236	Rendering tip 12
	0268 746	Rendering tip 14
	0268 747	Rendering tip 16
	0268 748	Rendering tip 18
	0268 726	Rendering tip set 14, 16, 18
6	2334 123	80-cm extension
	2339 400	150-cm extension
	2334 124	200-cm extension
7	2335 394	Glue attachment
8	2335 388	Fill/dosing attachment
9	Mortar hose (including air hose and control cable) for automatic spray lance (2334115, 2334121)	
	2334 131	Mortar hose DN 19 – 2 m, Connection V 25 incl. swivel joint
	2325 193	Mortar hose DN 19 – 10 m, Connection V 25
	2325 197	Mortar hose DN 25 – 10 m, Connection V 25
	2363 405	Mortar hose DN 35 – 13.3 m, Connection V 35
10	0342 314	Fix coupling seal M 27

ITEM	PART NO.	DESIGNATION
11	Mortar hose (including air hose) for pneumatic spray lance (2334122)	
	2324 927	Mortar hose DN 19 – 2 m, Connection V 25 incl. swivel joint
	2325 194	Mortar hose DN 19 – 10 m, Connection V 25
	2325 182	Mortar hose DN 25 – 10 m, Connection V 25
	2363 405	Mortar hose DN 35 – 13.3 m, Connection V 35
12	2337 672	Angled spray head
13	0342 916	Cleaning needle
14	0342 330	Cleaning ball for DN 19
	0342 331	Cleaning ball for DN 27
	0342 332	Cleaning ball for DN 35
15	0342 329	Bottle brush for cleaning the inside of the outlet unit and spray lance
16	9100 095	Brush with handle and protective cap (no picture)
17	0348 959	Cleaning brush (280-420 mm long, no picture)
18	0348 450	Tool box (without content)
19	9992 824	Pump sliding means 500 ml
20	0342 215	Hose holder
21	0342 241	Cleaning adapter M 27 – GK
	0348 948	Cleaning adapter M 35 – GK
22	2337 718	Compressor C330/03, 230 V~, 50 Hz,
23	2349 514	Water hose (no picture)
24	2311 644	Air Hose (no picture)
25	0342 321	Coupling reducer V35/M25 (no picture)
	0348 920	Coupling reducer V25/M35 (no picture)
26	2311 692	Control cable for automatic spray lance 14 m (no picture)
27	2312 136	Lubricant for mortar hose (Metylan wallpaper paste) 125g (no picture)

For work with the automatic spray lance, you need a stronger compressor (e.g. C330/03, accessory pos. 22).

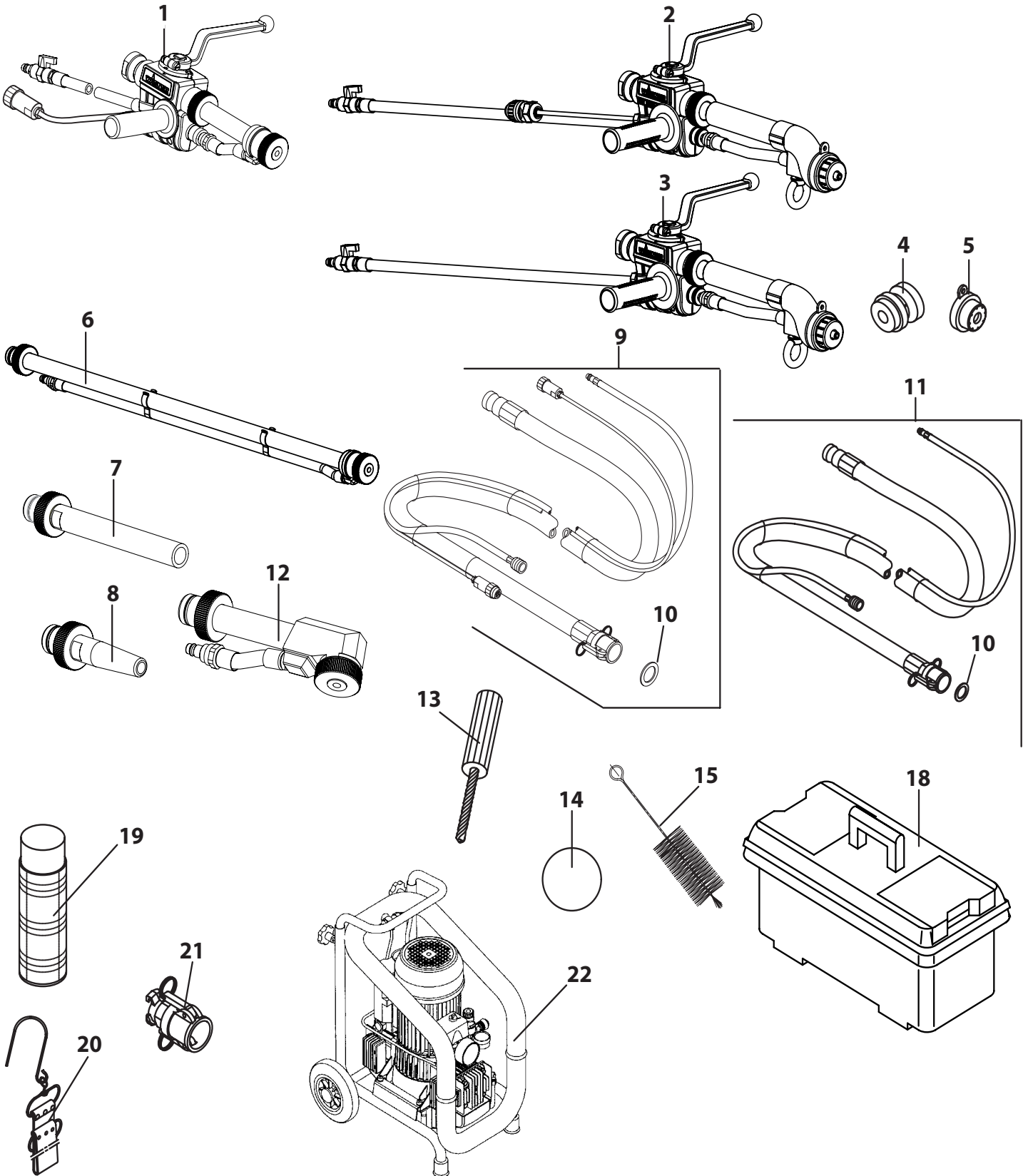

12 SPARE PARTS LIST

ITEM	PART NO.	DESIGNATION	ITEM	PART NO.	DESIGNATION
1	2367367	Container	35	2367440	Rear wheel, cpl.
2	2367368	Safety guard cpl.	36	2367452	Lever
3	2367369	Quick connector	37	2367453	Motor
4	2367370	Struts	38	2367454	Carrier
5	2367371	Vibration absorber	39	2367455	Casing, cpl.
6	2366671	Rotor	40	2367456	Seal
7	2366670	Stator	41	2367457	Sensor
8	2367382	Pressure gauge	42	2367450	Nut
9	2367383	Material connector	43	2370814	Washer
10	2367384	Outlet unit, cpl.	44	2370819	Bracket
11	2367385	Switch cabinet	45	2370815	Screw
12	2367386	Flange anchor	46	2370817	Washer
13	2367388	Splint	47	2370818	Screw
14	2367389	Flange nut	48	2406918	Water flow meter
15	2367390	Cleaning tool			
16	2367391	Compressor cpl.			
17	2367421	Compressor filter			
18	2367422	Scraper			
19	2367423	Absorber			
20	2367428	Absorber			
21	2367430	Mixer			
22	2367434	Clamp			
23	2367436	Spacer			
24	2367438	Front wheel			
25	2368772	Rear wheel, cpl. (including brake)			
26	2349166	Cordset			
27	2367441	Cleaning needle			
28	2367442	Pipe wrench			
29	2367443	Water pump filter			
30	2367444	Pressure gauge			
31	2367445	Pressure gauge			
32	2367446	Rapid action coupling			
33	2367447	Ball valve			
34	2367448	Water system, cpl.			

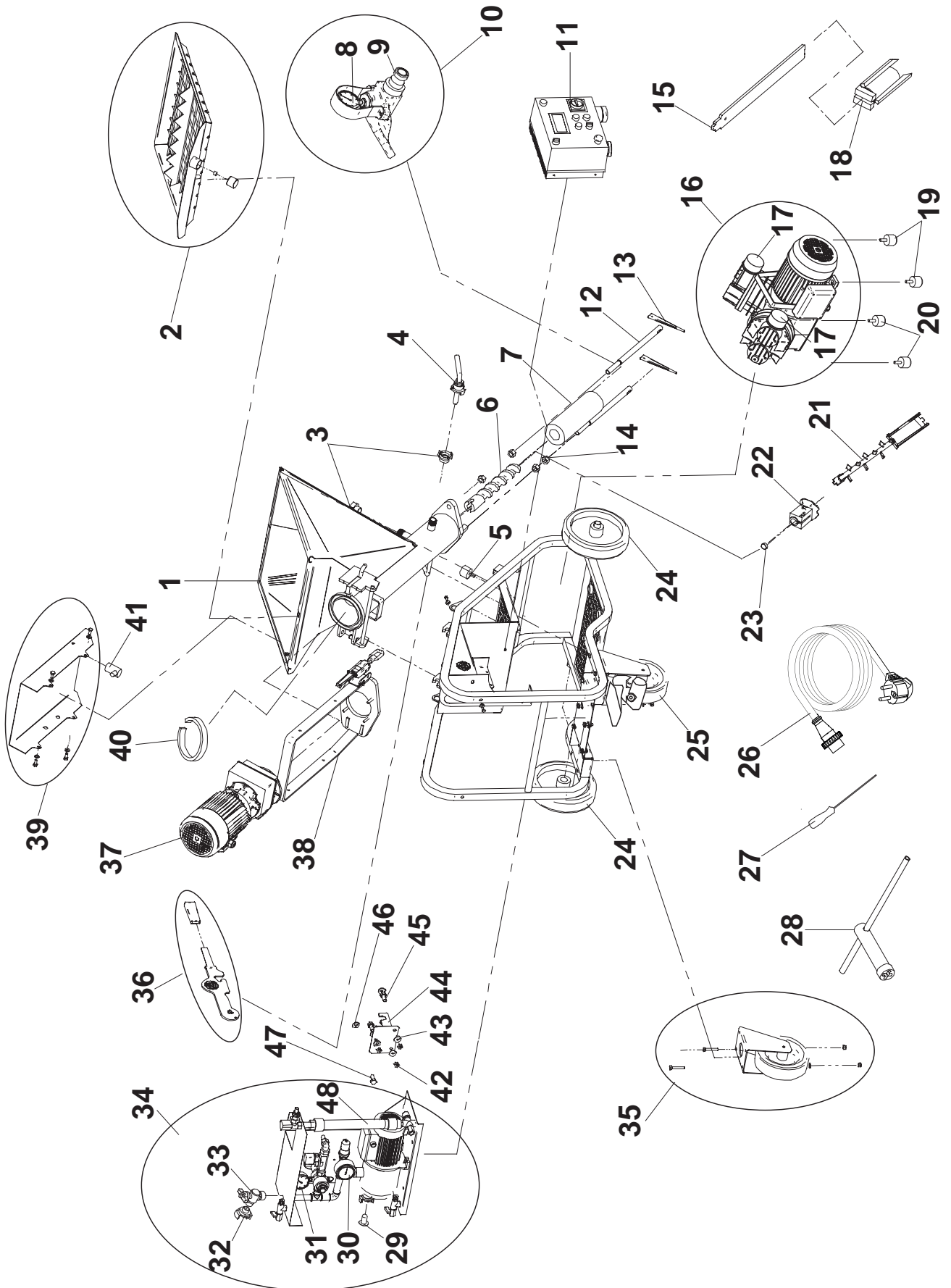

TESTING OF THE UNIT

For safety reasons, we would recommend having the device checked by an expert as required but at least every 12 months to ensure that it can continue to operate safely.

In the case of unused devices, the check can be postponed until they are next started up.

All (potentially deviating) national inspection and maintenance regulations must also be observed.

If you have any questions, please contact the customer service team at Wagner.

IMPORTANT INFORMATION ON PRODUCT LIABILITY

According to an EU directive, the manufacturer is only liable without limitation for faults in the product if all parts come from the manufacturer or have been approved by the manufacturer and have been mounted to the device and are operated properly. If third-party accessories or spare parts are used, the manufacturer is exonerated wholly or partly from his/her liability if use of the third-party accessories or spare parts have caused a defect in the product. In extreme cases, the relevant authorities can completely prohibit using the entire device. With original WAGNER accessories and spare parts, compliance with all safety regulations is guaranteed.

NOTE ON DISPOSAL

In observance of the European Directive 2002/96/EC on waste electrical and electronic equipment and implementation in accordance with national law, this product is not to be disposed of together with household waste material but must be recycled in an environmentally friendly way!



Wagner or one of our dealers will take back your used Wagner waste electrical or electronic equipment and will dispose of it for you in an environmentally friendly way. Please ask your local Wagner service centre or dealer for details or contact us direct.

WAGNER STANDARD GUARANTEE

(STATUS: 1ST AUGUST 2017)

The Standard Guarantee applies to all Professional Finishing products which are sold by WAGNER and the official WAGNER distributors after 1st August 2017 within the People's Republic of China.

STANDARD GUARANTEE TERMS & CONDITIONS

1. Scope of guarantee

All WAGNER professional application devices (hereafter referred to as products) are carefully inspected, tested and are subject to strict checks under WAGNER quality assurance.

WAGNER exclusively issues guarantees to customers who have purchased the product from an authorized distributor. The buyer's claim for liability for defects from the purchase agreement with the seller as well as statutory rights are not impaired by this guarantee.

We provide a guarantee in that we decide whether to replace or repair the product or individual parts. Replaced products or parts become our property.

This guarantee statement supersedes all previously printed guarantee collateral materials in China. WAGNER reserves the right to make changes to these terms at any time.

2. Guarantee period and registration

The standard guarantee period amounts

- to **12 months** for the following machines:
all HVLP and XVLP units like Flexio W890, FinishControl 3500, FinishControl 5000, CS 9100
all semi-professional airless units like ProjectPro 117, ProjectPro 119
- to **24 months** for the following machines:
all professional airless spraying units like piston pump, diaphragm pump etc.
- and all plaster spraying units like screw pump etc.
- for all machines to **12 months** for industrial use or equal wear, such as shift operations in particular, or in the event of rentals.

The guarantee period begins with the day of delivery by the authorized distributor or WAGNER. The date on the original purchase document is authoritative.

Proof of purchase (Fapiao invoice, original receipt, bank transfer slip, payment note or similar) that carries the date of the purchase and the serial number of the machine by the original end-user purchaser is required in case of a guarantee claim.

The standard guarantee is for the original end-user purchaser only. The guarantee is not transferable.

Parts replaced under guarantee are warranted to the end of the original guarantee period from the date of purchase. Parts replaced by an Authorized Service Center after the original guarantee period are warranted for 90 days from the date of service.

Once the guarantee period has expired, claims made against the guarantee or from the guarantee can no longer be enforced.

3. Handling

If defects can be seen in the materials, processing or performance of the device during the guarantee period, guarantee claims must be made immediately.

In addition, the customer should inspect the equipment immediately after receiving the product. The customer shall report to the authorized distributor or WAGNER any obvious defects of the new product within 14 days after receiving the goods, to avoid losing the right to complain.



The authorized distributor that delivered the device is entitled to accept guarantee claims. Guarantee claims may also be made to the service centers or WAGNER directly.

Central WAGNER repair address:

No. 198th, Chang Jian Road, Shanghai

Cell phone: 18621971777, 18621963777

For more information on service centers, please refer to WAGNER official WeChat channel or call 400 611 8808 for support.

The product has to be sent without charge or presented together with the original purchase document that includes details of the purchase date and the name and serial number of the product. The costs as well as the risk of loss or damage to the product in transit or by the centre that accepts the guarantee claims or who delivers the repaired product, are the responsibility of the customer.

Parts replaced under guarantee are warranted to the end of the original guarantee period from the date of purchase. Parts replaced by an Authorized Service Center after the original guarantee period are warranted for 90 days from the date of service.

4. Exclusion of guarantee

Standard guarantee claims cannot be considered

- for parts that are subject to wear and tear due to use or other natural wear and tear, as well as defects in the product that are a result of natural wear and tear, or wear and tear due to use. This includes in particular cables, valves, packaging, jets, cylinders, pistons, fluid wetted parts, filters, pipes, seals, rotors, stators, tips, etc. Damage due to wear and tear that is caused in particular by sanded coating materials, such as dispersions, plaster, putty, adhesives, glazes, quartz foundation.
- for the clutch assembly on a gas sprayer or striper.
- in the event of errors in devices that are due to non-compliance with the operating instructions, unsuitable or unprofessional use, incorrect assembly and/or commissioning by the buyer or by a third party, or utilization other than is intended, abnormal ambient conditions, unsuitable coating materials, unsuitable operating conditions, operation with the incorrect mains voltage supply/frequency, over operation or defective servicing or care and/or cleaning.
- for errors in the device that have been caused by using accessory parts, additional components or spare parts that are not original WAGNER parts.
- for products to which modifications or additions have been carried out.
- for products where the serial number has been removed or is illegible.
- for products to which attempts at repairs have been carried out by unauthorized persons.
- for products with slight deviations from the target prop-

erties, which are negligible with regard to the value and usability of the device.

- for products that have been partially or fully taken apart.

5. Additional regulations.

The above guarantees apply exclusively to products that have been bought by authorized distributor in the People's Republic of China and are used within the referenced country.

If the check shows that the case is not a guarantee case, repairs are carried out at the expense of the buyer.

The above regulations manage the legal relationship to us with reference to WAGNER Standard Guarantee.

Any additional claims, in particular for damages and losses of any type, which occur as a result of the customer's improper use of our products, are excluded from our product liability, unless otherwise stipulated by law or regulations. In addition, any claims for any losses, which are not caused directly from the products or the use of the products are also excluded from our product liability, unless otherwise stipulated by law or regulations.

Claims for liability for defects to the distributors remain unaffected.

Chinese law applies to this guarantee. The contractual language is Chinese. In the event that the meaning of the Chinese and a foreign text of this guarantee deviate from one another, the meaning of the Chinese text has priority. WAGNER Decorative Finishing reserves the right of final explanation.

WAGNER can do even more for you: Sign up and enjoy the free 2+1 pro-guarantee

In addition to our standard guarantee we offer a special service to all owners of Professional Finishing pumps in China: Become a member at the WAGNER Owner's Club today and get one additional free year of guarantee for your unit and enjoy many more advantages! We can do more for you because we offer trustable quality! Please scan the QR code to learn more:



Wagner Spraytech (Shanghai) Co., Ltd.
Division ProfessionalFinishing
1F, No. 58, 3rd Jiangchang Rd.
Shanghai 200436
China

Subject to modifications

Wagner Spraytech(Shanghai) Co., Ltd.
Division Professional Finishing
Flr 1, Building 10, No 58, 3 rd Jiangchang Rd
Shanghai 200436
China